

**Slinfold Park Golf Club, Stane Street, Slinfold, Horsham, West Sussex, RH13 0RE.**

**Planning Ref: DC/08/0622**

**NGR 510876 130965  
(TQ66090 53717)**

**Project No:3298  
Site Code: SGC08**

**ASE Report No. 2009179  
OASIS id:**



**Maggie Henderson**

**November 2009**

**Slinfold Park Golf Club, Stane Street, Slinfold, Horsham, West  
Sussex, RH13 0RE.**

**Planning Ref: DC/08/0622**

**NGR 510876 130965  
(TQ66090 53717)**

**Project No:3298  
Site Code: SGC08**

**ASE Report No. 2009179  
OASIS id:**

**Maggie Henderson**

**November 2009**

**Archaeology South-East  
Units 1 & 2  
2 Chapel Place  
Portslade  
East Sussex  
BN41 1DR**

**Tel: 01273 426830  
Fax: 01273 420866  
Email: [fau@ucl.ac.uk](mailto:fau@ucl.ac.uk)**

**Abstract**

*Archaeology South-East (ASE) were commissioned by Quantum Partner Ship, on behalf of their client, (Slinfold Park Golf Club), to undertake a watching brief at the Slinfold Park Golf Course, Slinfold, West Sussex during ground works associated with the access road alterations.*

*The monitored groundworks were not deep enough to expose the surface of the underlying natural geology and no archaeological finds, features or deposits were identified.*

## **CONTENTS**

- 1.0 Introduction**
- 2.0 Archaeological Background**
- 3.0 Archaeological Methodology**
- 4.0 Results**
- 5.0 The Finds and Environmental Samples**
- 6.0 Conclusion**

### **Acknowledgements**

### **SMR Summary Sheet OASIS Form**

### **FIGURES**

- Figure 1: Site Location
- Figure 2: Trench and Test Pit Location Plan

### **TABLES**

- Table 1: Quantification of Archive

## **1.0 INTRODUCTION**

### **1.1 Site Background**

1.1.1 Archaeology South-East (ASE), the contracting division of the Centre for Applied Archaeology, University College London (CAAUCL), were commissioned by Quantum Partnership on behalf of Slinfold Park Golf Club to undertake an archaeological watching brief during ground works associated with improvements to the existing access and associated landscaping at Slinfold Park Golf Club, Stane Street, Slinfold NGR 510876 130965 (Fig. 1) hereafter referred to as 'the site'.

### **1.2 Geology and Topography**

1.2.1 The underlying geology of the site is Horsham stone (BGS 302). The road surface slopes gradually upwards to the west towards the club house.

### **1.3 Planning Background**

1.3.1 Planning permission for the demolition of existing dwellings, alterations and extension to the existing clubhouse, replacement and relocation of the existing maintenance shed, and associated access and landscaping has been granted by Horsham District Council (Reference DC/08/0622). Condition 13 of this permission states the following:

*No development shall take place on the site until the applicant has secured the implementation of a programme of archaeological work in accordance with a written scheme of investigation which has been submitted by the applicant and approved in writing by the Local Planning Authority.*

*Reason: The site is of archaeological significance and it is important that it is recorded by excavation before it is destroyed by development.*

1.3.2 John Mills, Archaeologist, West Sussex County Council (WSCC), in his capacity as advisor to the Local Planning Authority on archaeological planning matters has been consulted with regards to the proposed scheme. The archaeological potential of the site has been gauged in relation to known archaeological sites and the location of chance archaeological finds in the surrounding area (Fig. 1). Based on this information and the scope of the redevelopment works it was deemed appropriate that an archaeological watching brief should be undertaken during intrusive ground works associated with improvements to the existing access and associated landscaping adjacent to Stane Street (Fig. 2).

1.3.3 A written Scheme of Investigation (WSI) was prepared by Archaeology South East in October 2008 (ASE 2008) in advance of the ground works and was submitted to John Mills for approval prior to the commencement of the site works.

#### **1.4 Aims and Objectives**

- 1.4.1 The general aim of the archaeological works was to ensure that finds and features of archaeological interest were properly examined and recorded.
- 1.4.2 Aims specific to the site required that a record of any evidence directly related to Stane Street such as associated roadside ditches, should be made, In addition to any structures or deposits directly related to roadside settlement adjacent to Stane Street.

#### **1.5 Scope of Report**

- 1.5.1 This report represents the findings of the watching brief undertaken by Maggie Henderson (Archaeologist) on the 13<sup>th</sup> of October 2009. The project was managed by Neil Griffin (fieldwork) and Jim Stevenson (post excavation).

**2.0 ARCHAEOLOGICAL BACKGROUND (Fig. 1)**

- 2.1** A 1km radial search of the HER record was undertaken during production of the WSI. This site background information is repeated below.
- 2.2** The area of Stane Street, a well known Roman road runs alongside the eastern edge of the golf course. Stane Street connected the two Roman cities of London (*Londinium*) and Chichester (*Noviomagus*). Its course is fossilised in the landscape by the modern A29 as it runs through Horsham District between the two staging posts of Alfoldean (near Slinfold) and Hardham (near Pulborough). As a result there is some potential for Romano-British remains at the site (buildings, field boundaries, burials etc).
- 2.3** An archaeological watching brief (SMR No. 7170 – MWS7225) on the other side of Stane Street at Spring Copse Business Park, Slinfold suggested that existing post medieval structures had already removed any potential archaeological stratum.
- 2.4** A bronze Roman vase handle was found near Slinfold (SMR No. 3621 – MWS490) almost directly on the other side of Stane Street to the site.
- 2.5** A medieval park at Dedisham, near Slinfold is mentioned in 1321 (SMR No. 2751 – MWS60). This is almost directly on the other side of Stane Street to the site.
- 2.6** Documentary sources (SMR No. 2750 – MWS59) suggest that a post medieval parkscape existed immediately south of the golf course, indeed the land is preserved as a historic parkscape today.
- 2.7** Five historic houses dating from the 16<sup>th</sup> to 18<sup>th</sup> are situated on Stane Street near Slinfold, on Park Street leading from Stane Street to Slinfold, and in Slinfold itself.

### 3.0 ARCHAEOLOGICAL METHODOLOGY

- 3.1** Groundworks were undertaken using a 5-ton machine equipped with a toothless bucket (Fig. 2). These ground works were monitored by an archaeologist until archaeological features or deposits, the undisturbed natural substrate or the development formation level were reached.
- 3.2** The monitored groundworks comprised excavation of a narrow trench to the south of the existing road to create wider access from Stone Street to the club house. The existing brick gate piers were removed and four slots excavated for the construction of footings for new piers.
- 3.3** A digital photographic record was kept throughout the works.
- 3.4** A measured plan was kept of the location of intrusive modern disturbances found on the site.
- 3.5** All contexts were recorded on standard pro forma recording sheets.

Number of Contexts	3
No. of files/paper record	1
Plan and sections sheets	0
Bulk Samples	0
Photographs	Digital, 1CD
Bulk finds	0
Registered finds	0
Environmental flots/residue	0

Table 1: Quantification of site archive

## 4.0 RESULTS

4.1 The site had been subject to considerable modern intrusive works including levelling for the insertion of the present concrete road surface and footings for the gate piers in addition to disturbance created by a number of modern services (particularly towards the western end of the TR1 and S1 - 2). Further disturbance was caused by landscaping and the planting of roadside shrubs.

List of recorded contexts

Number	Type	Description	Max. Length	Max. Width	Deposit Thickness
001	Deposit	Topsoil, humic clay silt.	All	All	150 mm
002	Deposit	Sandy gravel levelling layer	TR1	TR1	Max. 140 mm
003	Deposit	Subsoil, sandy silt	S1- 4	S1- 4	Max. 140 mm

### 4.2 Trench 1 (TR1 – Fig. 2)

4.2.1 The access road widening trench (TR1), abutting the southern side of the existing concrete road surface, was 11.80 m long and 0.70 m wide. It was excavated to a maximum depth of 0.30 m.

4.2.2 The concrete surface at 250 mm thick was abutted by a deposit of silty clay topsoil [001]. The 150 mm thick deposit of topsoil overlay a gravelly levelling deposit with fragments of modern brick [002] observed to a maximum depth of 140 mm. The levelling layer extended under the concrete surface visible to a depth of 70 mm as the required base of the trench had been reached at 300 mm below road surface, leaving any underlying deposits undisturbed.

4.2.3 No archaeological finds or features were observed in any of the excavated areas.

### 4.3 Investigative Pits (S1-S4)

4.3.1 Four small foundation slots (S1 – 4), one to each side of the concrete footings of the former brick gate piers were excavated.

4.3.2 Pits 1 and 2 (S1, S2 – Fig. 2)

The two pits situated at the western end of Trench 1 revealed garden soil to a depth of 150 mm overlying clay silt subsoil, [003], 150 mm thick situated at the southern end of the slots. The northern part of both pits had been disturbed by modern services and part of the concrete footings for the gate pier. No archaeological features, deposits or artefacts were present.

4.3.3 Pits 3 and 4 (S3, S4 – Fig. 2)

The north pits comprised garden soil to a depth of 150 mm over clay silt subsoil also observed to a depth of 150 mm, again the concrete base of the gate piers were visible. No archaeological features, deposits or artefacts were present.

## 5.0 THE FINDS AND ENVIRONMENTAL SAMPLES

- 5.1** No finds of archaeological interest were recovered.
- 5.2** There were no archaeological features or deposits suitable for environmental sampling present.

**6.0 CONCLUSION**

- 6.1** The monitored groundworks were not deep enough to expose the surface of the natural underlying geology (Horsham Stone) in Trench 1 or the four investigative slots (S1-S4).
- 6.2** No archaeological finds, features or deposits were identified during the watching brief. There was, consequently, no evidence relating to the Roman road, Stane Street.

### **ACKNOWLEDGEMENTS**

The co-operation and assistance of John Mills of West Sussex County Council is gratefully acknowledged.

### **BIBLIOGRAPHY**

ASE 2008 Slinfold Park Golf Club, Stane Street, Slinfold, Horsham, West Sussex, RH13 0RE: Archaeological Watching Brief, Written Scheme of Investigation

**SMR Summary Form**

Site Code	SGC08					
Identification Name and Address	Slinfold Park Golf Club, Stane Street, Slinfold, Horsham, West Sussex, RH13 0RE					
County, District &/or Borough	West Sussex					
OS Grid Refs.	510876 130965					
Geology	Horsham Stone					
Arch. South-East Project Number	3298					
Type of Fieldwork	Eval.	Excav.	Watching Brief√	Standing Structure	Survey	Other
Type of Site	Brown Field	Shallow Urban	Deep Urban	Other farm buildings		
Dates of Fieldwork	Eval.	Excav.	WB. 13 <sup>th</sup> October 2009	Other		
Sponsor/Client	Quantum Partnership on behalf of Slinfold Park Golf Club					
Project Manager	Neil Griffin					
Project Supervisor	Maggie Henderson					
Period Summary	Palaeo.	Meso.	Neo.	BA	IA	RB
	AS	MED	PM	Other Modern		
<p>100 Word Summary.</p> <p><i>Archaeology South-East (ASE) were commissioned by Quantum Partner Ship, on behalf of their client, (Slinfold Park Golf Club), to undertake a watching brief at the Slinfold Park Golf Course, Slinfold, West Sussex during ground works associated with the access road alterations.</i></p> <p><i>The monitored groundworks were not deep enough to expose the surface of the underlying natural geology and no archaeological finds, features or deposits were identified.</i></p>						

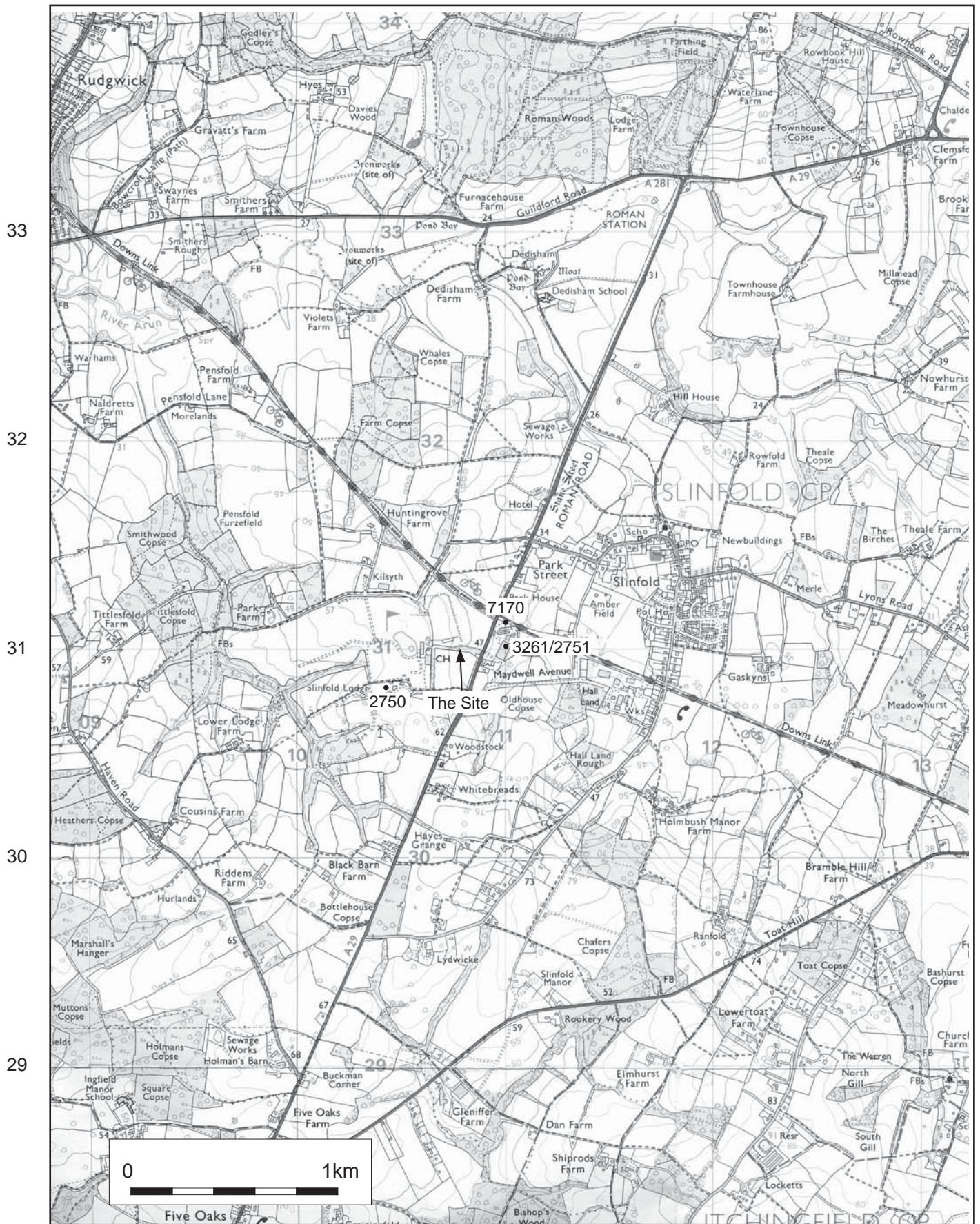

09                      10                      11                      12                      13

© Archaeology South-East		Slinfold Park Golf Club	Fig. 1
Project Ref: 3298	Oct 2008	Site Location Plan and selected WSCC HER data	
Report Ref: 2009179	Drawn by: JLR		

Reproduced from the Ordnance Survey's 1:25000 map of 1997 with permission of the Controller of Her Majesty's Stationary Office. Crown Copyright. Licence No. AL 503 10 A

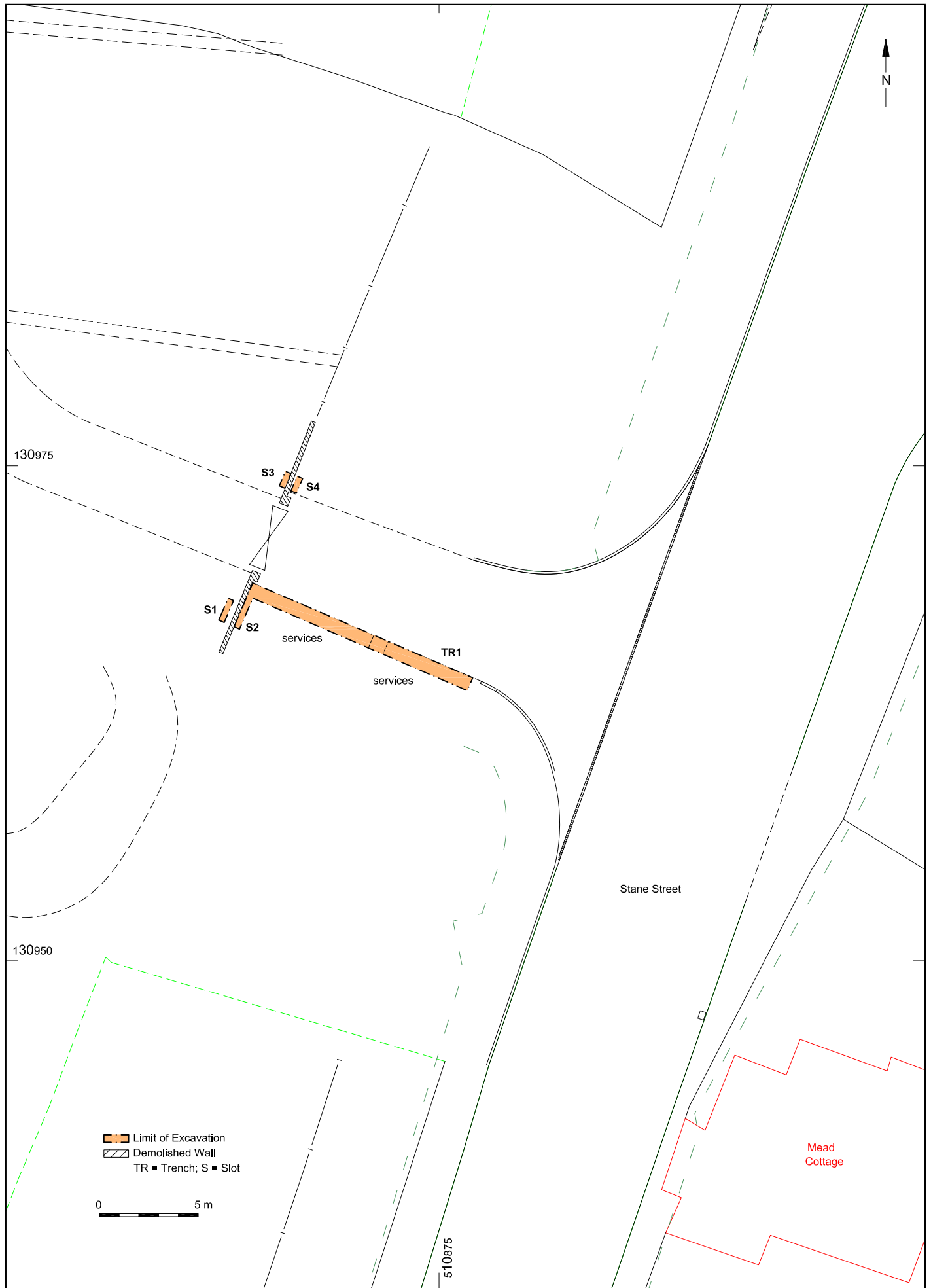

© Archaeology South-East		Slinfold Park Golf Course	Fig. 2
Project Ref: 3298	November 2009	Trench and Test Pit Location Plan	
Report Ref: 2009179	Drawn by: mh		

Head Office  
Units 1 & 2  
2 Chapel Place  
Portslade  
East Sussex BN41 1DR  
Tel: +44(0)1273 426830 Fax:+44(0)1273 420866  
email: [fau@ucl.ac.uk](mailto:fau@ucl.ac.uk)  
Web: [www.archaeologyse.co.uk](http://www.archaeologyse.co.uk)



London Office  
Centre for Applied Archaeology  
Institute of Archaeology  
University College London  
31-34 Gordon Square, London, WC1 0PY  
Tel: +44(0)20 7679 4778 Fax:+44(0)20 7383 2572  
Web: [www.ucl.ac.uk/caa](http://www.ucl.ac.uk/caa)

The contracts division of the Centre for Applied Archaeology, University College London 

©Archaeology South-East