

**An Archaeological Interpretative Survey of
Chillmill Manor, Brenchely, Kent**

Commissioned by David Nealon

on behalf of Mr and Mrs Schoorlemmer

**Project Ref. 3347
Report No. 2008237**



**by
David Martin FSA IHBC MIFA & Barbara Martin AIFA**

2008

**AN ARCHAEOLOGICAL
INTERPRETATIVE SURVEY
OF
CHILLMILL MANOR, BRENCHELY,
KENT**

**Commissioned by
DAVID NEALON, Chartered Designer
on behalf of
MR AND MRS SCHOORLEMMER**

PROJECT REF. 3347

**by
David Martin FSA IHBC MIFA
&
Barbara Martin AIFA**

**Archaeology South-East
Institute of Archaeology
University College London**

2008

STANDING BUILDINGS

ARCHAEOLOGICAL INTERPRETATIVE SURVEYS

AN INTRODUCTORY NOTE

ABOUT THESE SURVEYS

The intended purpose of an *Archaeological Interpretative Survey* is to give an overview of the date, sequence of construction, and principal architectural features of a building. As such, they should not be regarded as a detailed archaeological record, nor should they be taken as definitive. Further research, particularly that undertaken during building works, is likely to refine and extend the archaeological record.

These reports are aimed at three groups of user, namely those owners who wish to know more about their property, those persons (architects and planners) who are charged with the responsibility for both conserving the buildings and ensuring that they are carefully adapted to the needs of the future, and finally the academic carrying out wider historical or archaeological research,. A secure use for the future is, in our opinion, the only way of ensuring the long-term survival of any historical building.

INVESTIGATIVE TECHNIQUE

Unless noted to the contrary, the assessments involve a visual inspection of the fabric, both internally and externally, including any accessible roof voids and basement areas. Except where building works are being carried out, intrusive techniques are inappropriate. Interpretation of the fabric and fittings therefore relies principally upon inspection of the visible evidence. As part of the interpretative procedure, a measured outline survey of every property is undertaken.

THE WRITTEN REPORT







For ease of reference the written reports are divided into sections under a series of headings and sub-headings. The typical sequence of headings is as follows:-

- 1 Location of the building.
- 2 Sequence of development.
- 3 Detailed architectural description, arranged period-by-period.

THE DRAWINGS

A set of drawings produced from an measured outline survey is included within the body of each report. The purpose of these drawings is to identify the features included within the written text and to illustrate, as far as is known, the form of the structure during its various stages of development. For clarity the drawings have been prepared in the form of scale 'sketches', rather than detailed archaeological record drawings. For reasons of economy, the making of detailed archaeological drawings is restricted to stripped-out or exceptionally important buildings.

The symbols as used in the drawings attached to this report are as follows:

	Surviving Timber-Framed Wall
	Surviving Brick or Stone Wall
	Features evidenced but destroyed or masked from view
	Beam or feature immediately overhead
	Conjectural or very approximate
	Structural timber
	Details unknown or doubtful

OTHER CONVENTIONS USED -

1 Doors are shown in plan only where known: hence rooms may appear to have no obvious means of access.

2 With the exception of rafters, wallplates, and some chimneys and roof-lines, sections show features cut by or immediately adjacent to the cutting line only.

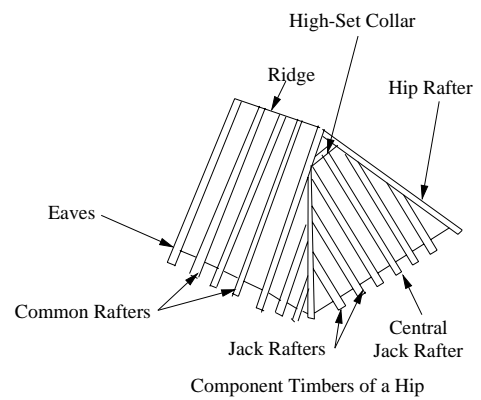
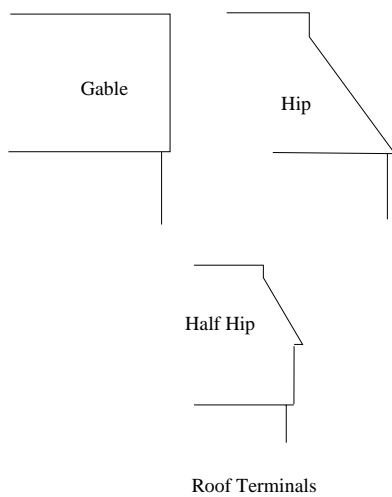
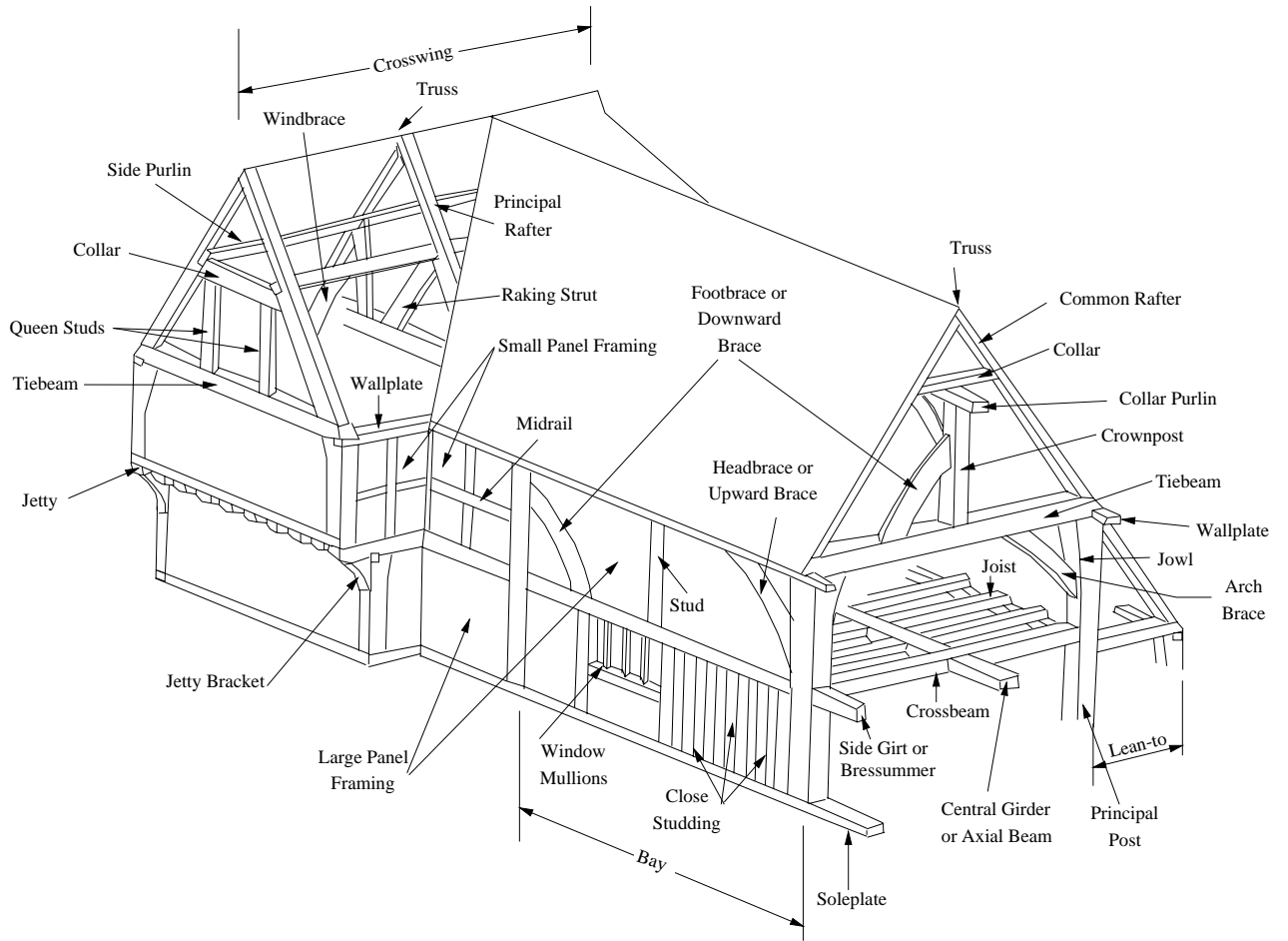

GLOSSARY OF PRINCIPAL TERMS

CHILLMILL MANOR, BRENCHLEY, KENT.

NGR TQ 6752 4078

LOCATION [Drawing No. 1]

Chillmill Manor is sited on the western side of Fairman's Lane which runs south from Brenchley to Lamberhurst, approximately 0.6 of a mile to the SSW of Brenchley Church. It stands at approximately 77 metres above mean sea level on the crest of a spur of high land. It is set back slightly from the road, to which it is aligned at a slight angle with its long axis orientated ENE-WSW (hereafter assumed E-W). The principal elevation faces SSE (hereafter assumed S) towards the road. To the west, between the house and road and built at right angles to both is a timber-framed barn (now converted and in separate ownership), whilst to the rear at the same end is an oasthouse (likewise now converted and in separate ownership) with a single-storeyed outbuilding running forward towards the house. Since before 1938 the house and outbuilding have been linked by a two-storeyed extension, but they are shown detached in the 1908 revision of the 1:2500 Ordnance Survey plan (see Drawing No. 1).

OVERVIEW OF THE BUILDING [Drawing No. 1]

Viewed from the road the overall shape of the house remains very much that of the mid 18th century when the present roof was built, but it is important to emphasise immediately that, in its detail, the present appearance (both internally and externally) is largely the result of a very extensive programme of restoration and rear extension work carried out in two phases between 1908 and 1938, probably in the 1920s. All the windows date from this period, as too does most of the secondary timberwork. Indeed, excluding the eastern end elevation (which has been restored to its historical form) and four restored (though blocked) windows, all that remains of the historical walls and partitions within the building are the principal members of the main frame and a few braces and studs. These timbers are shown in solid outline in the reconstruction drawings attached to this report. Excepting these, most of the visible timberwork in the walls and partitions dates from the early 20th-century restoration, apparently inspired by (and in some places retaining) the studwork of an earlier phase of restoration (mid/late 18th century) when the building was re-fenestrated and weatherclad. Ironically, although most timberwork is today exposed to view, the phase of alteration copied by the 20th-century restorers was one which introduced new studwork intended to support laths/battens, for their aim was to mask the timbers behind coverings. Despite the severity of the 20th-century restoration, the early development and much of the historical wall design can be reconstructed on paper based upon redundant mortices and peg holes visible in the timbers of the main frame. As far as can be told, all original daub infill within the building has been removed. It should be emphasised that the infill

timbering within the eastern end wall is an exception to the comments regarding the timbering made above and that the floor joisting and roof timbers were largely unaffected by the 20th-century restoration.

The earliest surviving part of the house at Chillmill is restricted to the eastern two end bays (*ie* the section to the east of the axial chimney). Based upon stylistic evidence, this part dates from the closing years of the 15th century [**Period B**]. It was built against the eastern end of a still earlier [**Period A**] house which at this time was retained, but was itself rebuilt subsequently. The period-B work is of high quality and houses a large ground-floor parlour with either one or two chambers over. It was either constructed to replace the earlier house's in-line parlour, or as an enlargement to the original building, aimed at increasing the private accommodation.

In the late 16th/early 17th century [**Period C**] the period-A part of the structure was demolished and replaced by a new four-bay section incorporating services at the western end and a large centrally-placed floored-over hall heated by a fireplace in the new three-flue chimney built within a narrow bay adjacent to the retained period-B parlour. Although the house was thus designed to be heated, all evidenced windows within the rebuilt part were of unglazed type. The upper chambers were ceiled, indicating that the attic area was most likely intended to be utilized, probably for storage.

The next identifiable phase of modification was carried out in the mid 18th century [**Period D**] and appears to have involved a thorough upgrade. These works included the reconstruction of the roof to a lower pitch using staggered-butt-purlin construction, seemingly incorporating dormer windows (since removed) in the front slope. The extent of the early 20th-century restorations makes it impossible to prove the timing beyond doubt, but it was probably as part of this phase of modernizations that the house was totally re-fenestrated, the external framing clad, and the internal partitions largely rebuilt, but retaining the earlier room layout. This work involved the insertion of regularly-spaced studs to support external cladding and internal lath and plaster coverings. The earlier windows were replaced at this date by larger openings, thereby giving extra



Plate 1
Methersham, Beckley, showing pentice roof.

light and a more up-to-date external appearance. The pentice roof running along the front facade is, in its present form, a 20th-century reconstruction, but probably replicates a feature added at this period, for although the present version forms part of the restoration undertaken between 1908 and 1938, a pentice seems to be indicated in the pre-restoration 1908 1:2500 O.S. plan. Similar pentice roofs exist in a number of local houses of this period, as, for instance, at Methersham Farm, Beckley, East Sussex, shown in Plate 1.

In the late 18th century (or perhaps during the opening years of the 19th century) the ground-floor part of the western end wall was replaced in Flemish-bonded brickwork incorporating some burnt headers. Today a blocked and encased fireplace stands against the internal face of this wall, but the bonding within the external wall contains nothing to suggest that the fireplace is the same date as the wall. Based upon the visible data it seems to be built against it and most likely represents a 19th-century addition. The chimney incorporates a single flue and has a square cap which rises through the half hip of the period-D roof. The fireplace most likely served a wash house/bakehouse. It was probably the introduction of this fireplace which necessitated the removal of the cross partition which formerly divided the two service rooms at this end of the house.

The early 20th-century map evidence shows that by 1908 an extension (probably in the form of a lean-to outshut) had been added across much of the eastern end wall of the house, hiding the jetty from view. This extension was destroyed as part of the major 1908x1938 restoration and is therefore impossible to date, but by 1908 it could already have existed for some time. By 1908 a further small extension (again of unknown date) had been added at the western end: this too was demolished between 1908 and 1938. A well is marked adjacent to it in the 1908 O.S. plan and this still remains.

As already indicated, it was between 1908 and 1938 that the major phase of modern restoration and refurbishment was carried out and it is this which gives the building its present appearance. The house was returned to its original length by demolishing the two minor additions at each end. All new additions were kept out of sight to the rear, where a long brick-built extension was constructed running the entire length of the house. This gave extra rooms at each end and providing long corridors on both floors, allowing independent access (via a new stairs) to all ground-floor rooms and first-floor chambers. [The extension was originally constructed with a flat roof, but in recent years this has been replaced by a pitched roof.] The old part of the house itself was very extensively renovated and repaired, removing the weather claddings from the front and eastern end, removing all internal plasterwork and replacing decayed period-D inserted timberwork. As much of the timber was left exposed as possible, even though many of the timbers in question were originally meant to be concealed. In places secondhand timbers were inserted to augment the aesthetics. A few period-B and period-C features were restored to their original form, and this especially relates to windows. The result is an odd mix of modern windows and blocked restored unglazed windows set adjacent to one another. In the front elevation, at the extreme eastern end, is a planted-on external brace which in its proportions vaguely mimics an extant internally-exposed brace. This

was presumably added for aesthetic effect.

The structural evidence and O.S. plans show that already by 1938 further alterations had been made to the house. Principal of these was a two-storeyed extension added at the western end, projecting northwards so as to connect the house to the rear outbuilding attached to the oasthouse. The west elevation of the addition uses 'mock Tudor' false framing so as to blend it to the existing. The projecting front porch is not shown in the 1938 revision of the 1:2500 O.S. plan (which appears to be accurate in all other respects) and therefore this almost certainly represents a post-1938 addition.

All work carried out since period D is excluded from the more detailed architectural description which follows.

LISTED STATUS OF THE BUILDING

Chillmill Manor (described as Chill Mill, Fairmans Lane, Brenchley) was listed grade II on 10th October 1954, its listed building reference being TQ 64 SE 6/75. The description in the list entry is purely for the purpose of recognition. Based upon an external inspection only, the date is given as probably late C16/early C17. [Source: English Heritage, Images of England - website]. The description must not be treated as a comprehensive schedule of those elements which are legally protected as, no matter what the grade, the legislative cover not only relates to both the interior and exterior, but also extends to any building within the curtilage which predates the 1st July 1948.

DETAILED ARCHITECTURAL DESCRIPTION

PERIOD A (Medieval) [See Drawing No. 1]

Although the two eastern bays of the present building are the earliest extant remains upon the site, they do not form a house in their own right. Furthermore, the western face of the westernmost period-B truss (E-E) is neatly stop chamfered at tiebeam level, indicating that the frame must have been constructed against an earlier house which was initially retained. Whether the extant part was built as an addition to a house of similar width and height, or whether it was constructed against a lower, smaller house with the intention of subsequently rebuilding that part also is impossible to tell — both scenarios are commonly encountered. The period-B work seems, from its design, to have been built as high-quality private accommodation, so it seems safe to assume that the missing period-A part contained the medieval open hall and associated service accommodation. Beyond this, nothing further can at present be said regarding this phase in the building's development.

PERIOD B (Late 15th C) [See Drawing Nos. 2-6]

LAYOUT

As has already been mentioned above, the present 7.70 metre x 6.60 metre (25'3" x 21'8") two-bay eastern end of the house represents an extension to an earlier house, though perhaps in itself replacing an earlier structure upon the same site. The period-B frame incorporates an eastern end jetty. On the ground floor the two bays formed a single large room with a very impressive c.2.70 metre (c.8'10") storey height measured from original floor level to underside of the joists. This room was entered from the earlier building to the west via an off-centred doorway (evidenced by mortices in the crossbeam). The arrangement on the first floor is in more doubt. Today this space too functions as a single room, but cut into the soffit of the tiebeam which crosses the chamber are not only mortices for a pair of former arch braces which rose from the principal posts, but also stave holes for a former partition. It is possible that the tiebeam represents a later repair reusing a secondhand timber, but there are no obvious indications that this is the case — in fact all the evidence suggests to the contrary. It therefore seems likely that there were originally two chambers at this level. The problem is, there is no evidence for a doorway through the alleged partition, so if there were two chambers both must have been reached from the room below via their own staircases. There is today no evidence for one, let alone two former stair traps through the floor joisting, but sufficient of the joists have been replaced in modern times for the evidence to have been removed. A further complication is the fact that the windows in the three external walls are arranged as pairs of centrally-placed openings, an arrangement which would best suit a single large two-bay first-floor chamber. However, this arrangement could have been chosen in the interests of external symmetry, repeating the similar arrangement which is known to have existed on the ground floor. Regardless of whether built to accommodate one or two chambers, the first-floor area seems originally to have been open to the roof — a usual feature at this period. The height of the walls at this level is less generous than on the ground floor, though at 2.00 metres (6'7") measured from first floor to top of wallplate, they are, nonetheless, more lofty than in most houses of this period.

WALL DESIGN

The parlour is well built and uses good-quality timbers, neatly finished and of average or slightly above average scantling. The prefabricated frame has swelling jowls to its principal posts, which support the wallplates and tiebeams in normal assembly. All the principal timbers have neatly chamfered edges terminated using stepped and splay-cut/hollowed stops. Mortices indicate that the north, south and eastern external walls were close studded at both ground- and first-floor levels, though only that in the eastern end wall and over one former window in the front elevation now survives *in situ*. Although originally internal, the western wall (truss E-E) which formerly abutted the earlier building was likewise close studded at the lower level, though here the studs

were more widely spaced. The situation on the first floor cannot at present be ascertained. The close studding generally was of typical local 'plank-like' type which means that internally most of the studwork was intended to be masked from view by the lath-and-daub infill: only the thicker principal studs which acted as window jambs were left visible. The frame was triangulated at both ground-floor and first-floor level by footbraces, some of which remain, whilst others are evidenced by pegged mortices. These braces passed across the internal face of the close studding and were left visible internally, but were concealed from view on the exterior by the close studding. Most of this wall design was destroyed during later alterations, but the arrangement still survives (partially altered and somewhat restored) within the eastern end wall.

As has been mentioned above under 'layout', there is evidence to suggest that the first-floor may have been divided into two by a stave partition (without studs) set beneath the central tiebeam. All the stave holes have been neatly blocked. Regardless of whether this truss was of open or closed type, mortices in both principal posts and in the tiebeam indicate that it was triangulated by means of arch braces.

NOTE: Another curious set of blocked-in mortices are visible under part of the crossbeam of truss F-F, turning and extending along the underside of a joist in bay E-F. However, the layout of the mortices is ragged and the alignment of that part of the partition running along the underside of the joist clashes with the period-C fireplace. It is almost certain that these mortices relate to a late (post-period-C/D) partition added at a time when this end of the house was divided up and in use as storage/work rooms.

WINDOWS

Each of the three external walls originally incorporated a pair of centrally-placed unglazed windows on each floor, those on the ground floor within the eastern end wall being slightly off centred on account of the jetty bracket fitted into the shared central jamb between the two — because the jetty bracket has to rise to a joist and there are an even (rather than odd) number of joists, the jamb is positioned slightly off centre to the building.

Due to the excessive storey height, all the period-B window openings on the ground floor had dropped heads set a little distance below crossbeam/side-girt level, with the panels above them infilled with close studding. Those in the eastern end wall, together with one in the front elevation survive: the others are evidenced by mortices only. The only ground-floor window cill to survive is the southern of the two in the eastern end wall. Internally its lower leading edge is neatly stop chamfered. It is uncertain whether the windows at this level were of diamond-mullioned type (as on the first floor) or whether of more elaborate design — the evidence is currently hidden.

At first-floor level the undersides of the wallplates and eastern tiebeam form the window heads, and here there are neat grooves for former sliding shutters. All the evidenced windows at this level are of five unglazed lights and originally incorporated diamond-

section mullions. Some of the blocked openings retain their mullions, but in all instances these are early 20th-century restorations reinstated into original mortices. There is some evidence to suggest that the window cills have been cut back flush with the wall face and that they formerly projected proud on the interior in order to support the shutters.

DOORWAYS

Sufficient evidence remains to show that there were originally no doorways in the external walls — the present eastern doorway is an altered window and the door-like blocked opening in the south wall is likewise a modified window. Access into the period-B structure from the remainder of the house was via an off-centred ground-floor doorway in truss E-E, the location of which is evidenced by the pegged mortices for its jambs, between which are stave holes (rather than mortices for close studding).

FLOORS AND CEILINGS

The c.160 mm x 140 mm ceiling joists within the eastern two bays are aligned east-west along the axis of the structure, being jointed at centre span into the crossbeam at truss F-F. At the eastern end wall the joists run over the crossbeam and continue eastwards to support the jettied-out section of the first-floor wall. The joist ends were never masked by a moulded fascia beam, but are instead slightly rounded. Beneath the jetty are three plain brackets, one at either end and a further one rising to joint into the sixth joist from the south. This is slightly off centred on account of their being an even number of joists. Unusually for the period, all joists are neatly stop chamfered.

The first-floor chamber(s) appears to have been open to the roof at this date, though ceilings were added later. The inserted ceiling appears to have been at least partially reconstructed at some date, for the tiebeam at truss F-F shows narrow mortices for a ceiling which predates the present one.

STAIRS

It is not known how access was gained to the first-floor chamber(s) at this period. Several of the floor joists within each of the two bays represent modern replacements: it is entirely likely that at least some of this work was associated with the removal of unsightly blocked stair trimmings when the joists were re-exposed to view as part of the restoration work.

CHIMNEYS

As is usual at this date, the parlour bay appears to have been unheated during its

period-B phase.

ROOF

The roof was entirely reconstructed during the mid 18th century (see Period D), though it may be relevant that this replacement uses secondhand rafters reused on their side, and at least some of these are from a medieval paired-rafter-and-collar roof. Because the top faces of the tiebeams are masked from view, it is not known whether the period-B roof incorporated crownposts. For the same reason, it is not known whether the eastern roof terminal was of gabled or hipped type. A high-level weathering course on the chimney cap suggests that the period-B/C roof was slightly more steeply pitched than its replacement.

PERIOD C (Late 16th/Early 17th C) [See Drawing Nos. 2-6]

LAYOUT

Either late in the 16th century or (perhaps less likely) early in the 17th century the western period-A part of the house was demolished and replaced by a new four-bay, in-line timber-framed range which measured 11.40 metres x 6.55 metres (37'5" x 21'6"), giving a very respectable 19.10 metre (62'8") length for the building at this date. The period-C frame is designed to be the same height as that of its period-B neighbour but, because of its slightly narrower width (about 70 mm or 3") there is a slight offset in the rear wall — this is likely to be due to an inaccurate measurement for the width of the existing frame taken prior to fabrication of the new section.

Against the western wall of the period-B parlour is incorporated a narrow bay designed to accommodate the new axial three-flue chimney, with a stair area to the rear and an entrance lobby to the fore. To the west is the single-bay main living room of the house (the hall) and, beyond that, two service rooms set in tandem. The service room in the narrow western bay incorporated an additional stair in its south-western corner. A chimney now occupies a large part of this bay, but this represents an insertion and there are no visible indications that it replaces an earlier chimney on the same site — indeed, given the original small size of the room, almost certainly it does not.

Unlike on the ground floor, on the first floor the two western bays formed a single large chamber, whilst the adjacent hall chamber reflects the size of the hall below. The main stairs to the first floor rose against the northern wall of the chimney and must have given access to both the unheated hall chamber and to the two-bay heated parlour chamber within the period-B part. What is significant is that at this date there was no first-floor doorway through truss C-C and thus the two-bay service chamber was accessed via its own stairs only. This phenomenon was common during the 16th century, but was going out of use — particularly in a house of this large size — by

the late 16th century.

WALL DESIGN

Unfortunately the period-D alterations and the renovations of the early 20th century have disguised much of the design of the wall framing, the present infill framing being a mix comprising a little late 16th/early 17th century timbering, some early/mid 18th century replacement infill framing comprising slender regular-spaced studs, and early 20th-century restoration/replacement. The peg holes and mortices which allow parts of the period-C frame to be reconstructed are sufficient to indicate large-panel framing with footbraces at first-floor level, these apparently being exposed to view externally. Thus the period-C framing is less expensively designed than that of the preceding phase and does not follow the design used during period B, resulting in a marked and very obvious difference in the appearance of the two parts. This point has been totally disguised by the early 20th-century restorations.

Internally, footbraces survive at first-floor level within the cross partition at truss C-C, dividing the hall chamber from the service chamber, and this partition also includes two original studs. As already noted, these two chambers were at this date not interconnected — the present doorway represents an insertion added against one of the two existing studs, with the southern jamb merely notched into position, hence the need for the two separate staircases. The ground-floor part of this partition has been entirely rebuilt to a revised design, but peg holes indicate it originally incorporated three equal-width panels with a doorway at the northern end. The ground-floor partition within truss B-B has been totally removed, but here too peg holes, mortices, and stave holes allow the original design to be reconstructed. It comprised three large panels of infill with a doorway to the north (leading into the western service room) and another to the south (leading to the former staircase).

Access to the closet area over the entry was from the more important parlour chamber rather than the hall chamber.

WINDOWS

Just visible over the modern window lighting the hall chamber are the points of diamond-section mortices for a former unglazed window. The location of one other window (serving the service chamber) is evidenced in the front wall, whilst three window positions are recognizable in the rear wall, one (now reinstated and restored) serving the hall chamber, a second immediately beneath it, lighting the hall, and the third set against the principal post of truss C-C, lighting the service chamber.

DOORWAYS

Access to the house during period C was via a doorway set immediately to the south of the chimney, evidenced within the side girt by a cut in the soffit. The doorway gave direct access into the lobby. Reference has already been made to the evidenced internal doorways (see 'Wall Design' above): all are entirely plain.

At this period the parlour was reached direct from the lobby via an intruded doorway, this revised door location being necessary because the earlier period-B doorway was by now blocked by the chimney. The closet above the entry was reached from the parlour chamber via an intruded dropped-headed doorway. A further doorway would have been intruded at the northern end of this partition so as to allow access into the parlour chamber from the stairs, but this was destroyed during the early 20th-century alterations when new doorways were intruded through the rear wall, leading in from the northern extension.

FLOORS AND CEILINGS

Within the ceiling over the hall the joists run north-south, being jointed into a central girder which has chamfered lower leading edges. The chamfers are terminated by bold bar-panel-and-cyma stops of a type more in keeping in design with the 17th century than the 16th century. The joists within this bay measure 120 mm wide, are plain, and appear originally to have been masked from view by an under-plastered ceiling. Because of the short length of the bays, within the two service rooms the joists run east-west, along the axis of the building.

On the first floor the ceilings within both the hall chamber and the service chamber are of central-girder type, the girders being chamfered along their lower leading edges, as too is the tiebeam of truss B-B. The girders have cyma stops, whereas the chamfers on the tiebeam of truss B-B have simple run-out stops, terminating the chamfers on either side of the girder.

At this date (if not before) the parlour chamber was ceiled over using joists which running east-west. It should be borne in mind that there are redundant mortices for narrow joists in the side face of the tiebeam of truss F-F. This probably indicates that the initial joisting in this area was intended to serve solely as a ceiling and did not double as an attic floor. The change of joists probably indicates the date at which this part of the roof was brought into use, but whether this occurred during period C (a ceiling having already been added into this area by then) or during period D when the roof was rebuilt is at present impossible to say.

STAIRS

The period-C house incorporated two flights of stairs giving access to the first floor

chambers. To judge from a cut-out section in the eastern face of truss D-D, the main stairs were positioned in one of the traditional locations for the period, adjacent to the rear (northern) jamb of the hall fireplace. This allowed access to both the parlour and hall chambers. Access to the service chamber was via a stair located against the southern wall of the western service room. Here too the stair is evidenced by a cut out in the reverse face of the crossbeam.

Access to the attic area appears to have been by a flight rising above the main ground-floor stair adjacent to the chimney. Potentially this could have given access to both the attic over the parlour chamber and that over the hall and service chambers, as indeed was the case during period D, but all depends upon the date of the structural attic floor within the eastern two bays (see above).

CHIMNEYS

The axial three-flue chimney incorporated fireplaces serving the hall, parlour and parlour chambers: all are now somewhat altered and restored. The inglenook serving the hall is not set completely flush with the crossbeam, but projects slightly into the room at its northern jamb — perhaps the result of historic settlement. Later brick piers reinforce the jambs of the fireplace, masking any side seats which may have existed. Within the rear wall is a rectangular recess. A blocking towards the southern end of the lintel seems to indicate the location of a former clockwork spit mechanism. As is usual, the fireplace serving the parlour is smaller than that within the hall. This too has been brick encased, but retains its plain timber lintel. On the first floor the fireplace serving the parlour chamber is blocked, but its timber lintel remains exposed. Externally the chimney cap (largely rebuilt) shows its three rebated flues to the front, but is plain at the rear.

ROOF

No details of the roof construction are currently known, the present roof structure being of mid 18th century date (see 'Period D').

PERIOD D (Mid 18th Century) [Drawing No. 7]

LAYOUT

Except for cutting through a first-floor doorway within truss C-C and the probable removal of the service staircase, no period-D alterations are recognizable to the internal layout of the house, this despite the extensive nature of the renovations made to the building at this time. A cut-in stair trimming in the first-floor ceiling, adjacent to the partition dividing the hall chamber from the service chamber, may belong to this period.

The stairs have since been removed and the trimming infilled.

WALL DESIGN AND WINDOWS

As already noted, it was during this general period that the external walls were weather clad, the earlier infill framing being replaced by regularly-set thin studs in order to adequately support the external cladding and rebuilt internal lath-and-plaster partitions. Due to the extent of the early 20th-century restorations, it is difficult now to ascertain what specific alterations were made to the wall framing at this date, but the work seems to have involved upgrading the whole building and re-positioning the windows (all are now 20th-century timber casements). Although now removed, evidence suggests that at this date there were three dormer windows lighting the attic rooms (see 'Roof' below).

FLOORS AND CEILINGS

Unless the ceiling in the period-B parlour chamber was rebuilt at this time (see above) no alterations belonging to this date are recognizable. Generally throughout the house under-plaster ceilings were at some date fitted to the underside of the joists (perhaps during period C, perhaps during this period) but the plaster has since been removed and thus the age cannot be ascertained.

ROOF

Despite the considerable re-infilling of the walls, the principal structural alteration of this period involved the total reconstruction of the roof, almost certainly to a slightly lower pitch than previously. The present period-D roof is of staggered-butt-purlin construction, reusing many of the earlier rafters as its new common rafters — some are of medieval date and are halved for collars. Like the purlins, the principal rafters which support the butt purlins are not secondhand, but were purpose cut for the roof. They rise immediately above the tiebeams and are linked by collars, but the internal roof trusses are absent of queen studs or other infill timberwork. Both roof terminals are half hips (absent of high-set collars at their apex) supported by regularly-studded stub gables, possibly incorporating windows beneath the collars. At three points positioned to a regular pattern within the front roof slope a single peg hole is absent from the lower edge of the purlin, suggesting the absence of a period-D rafter at these points. Although this in itself is not proof, it suggests the locations of three dormer windows, all now removed (see Longitudinal Section in Drawing No. 7). The use of dormer windows to augment light within attic spaces and to enhance the appearance of the front elevation is not uncommon at this period where attic areas are being brought into more common use.

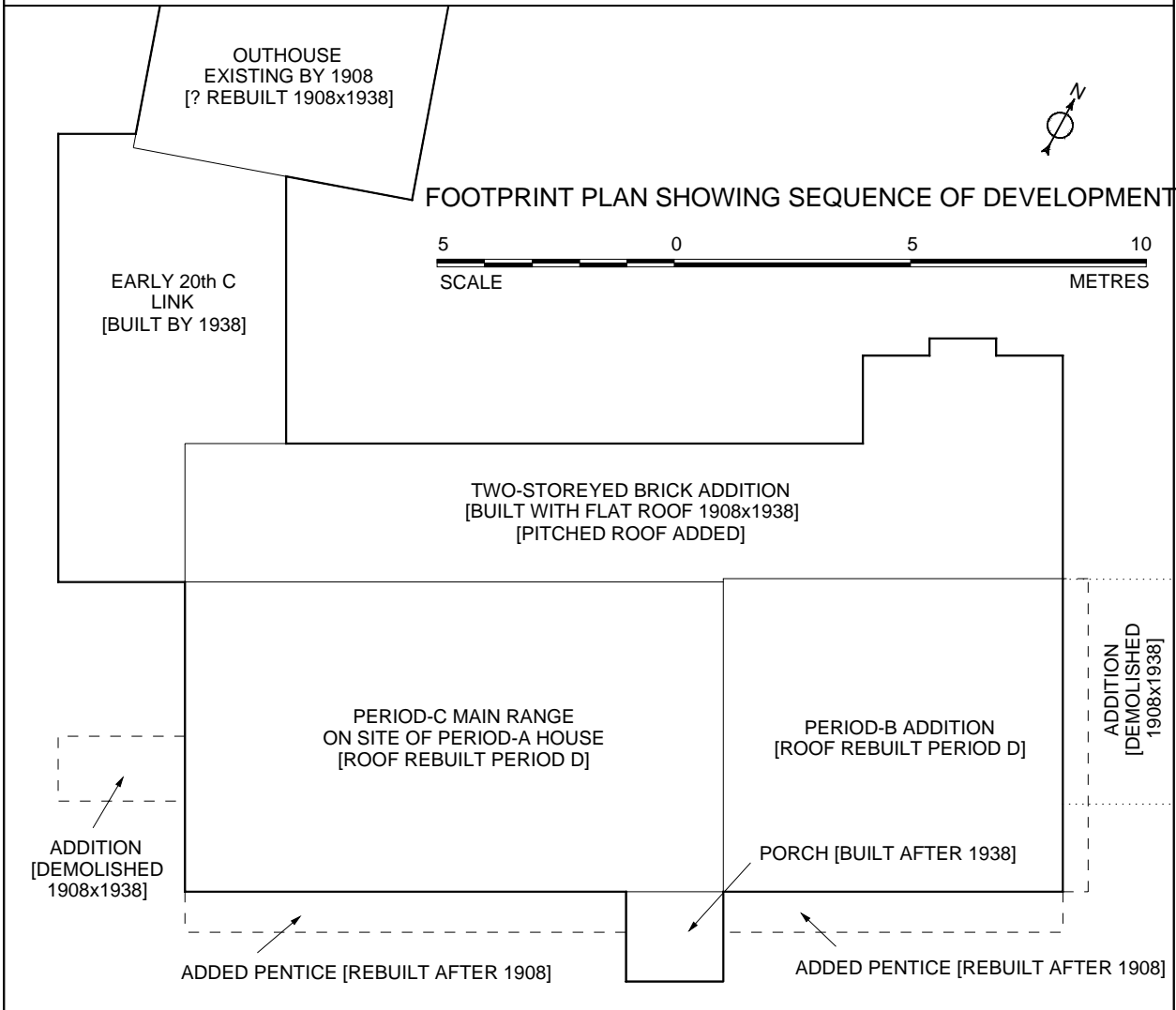
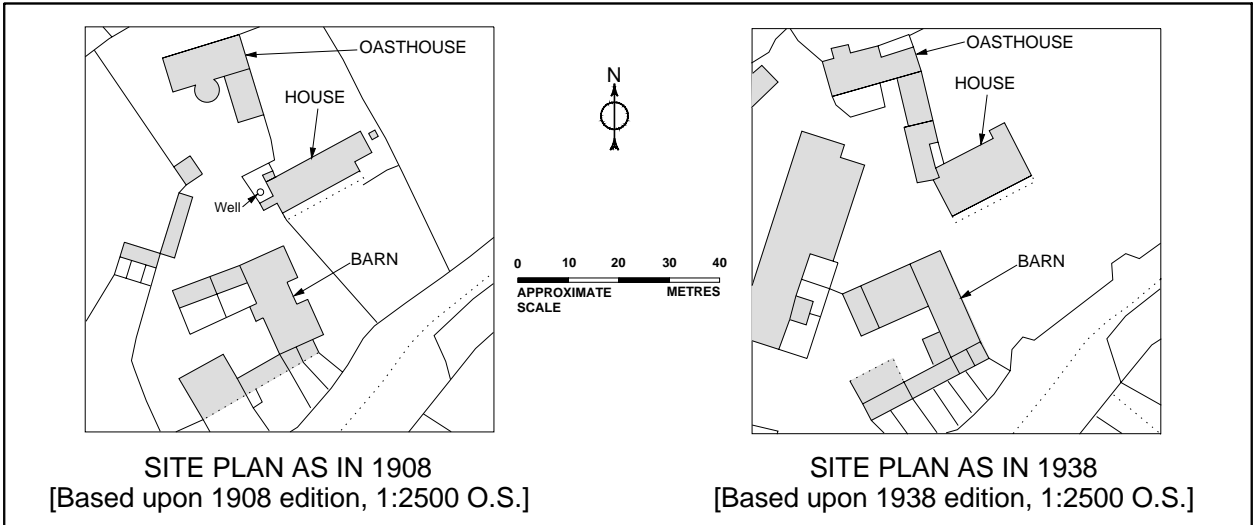

CHILLMILL MANOR, BRENCLEY, KENT				Project Ref	3347
HISTORICAL MAPS AND DEVELOPMENT PLAN				Drawing No.	1
Drawn By	J Clubb	Revision No	-	Date of original survey	2008
				Date of this revision	2008

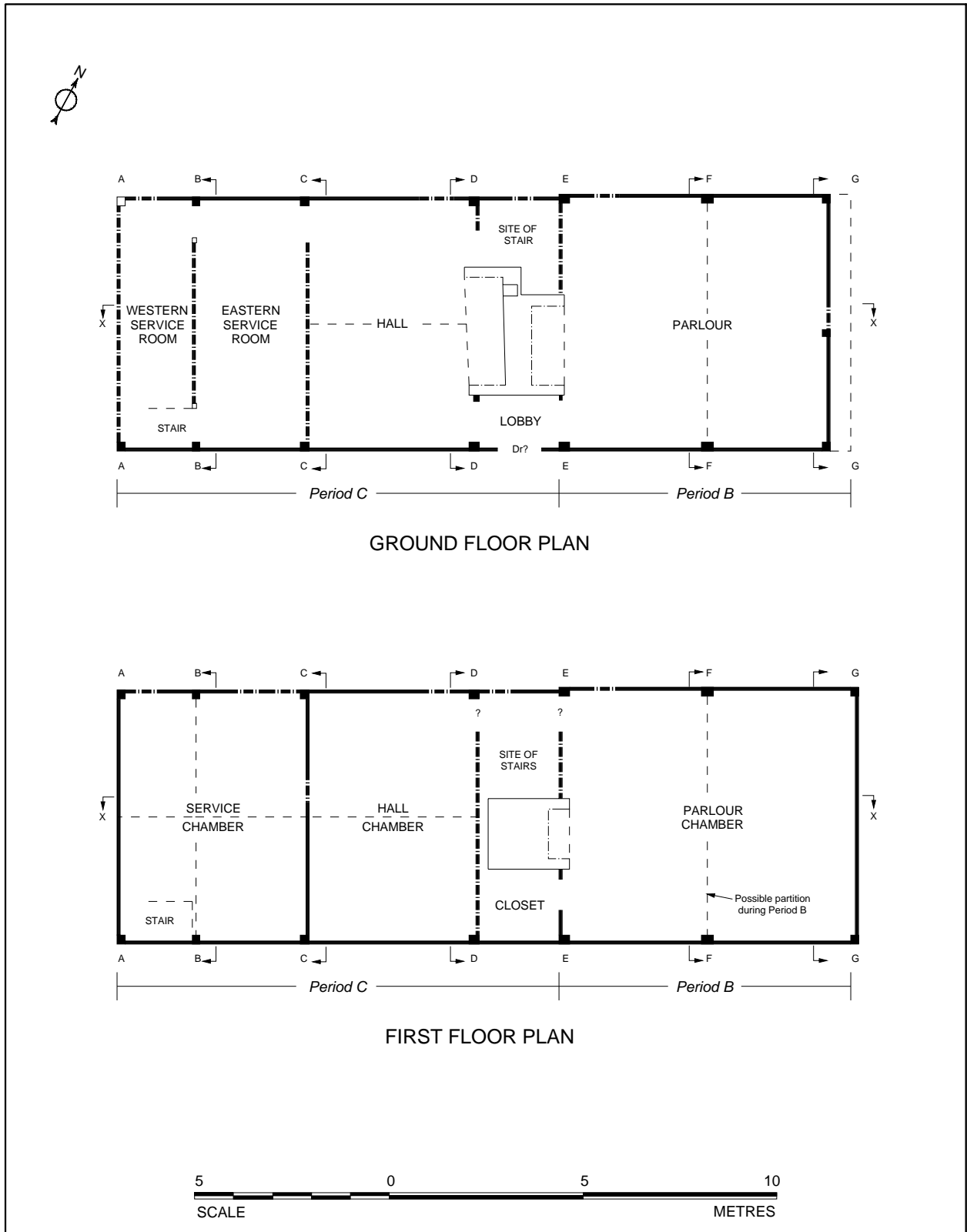

CHILLMILL MANOR, BRENCHLEY, KENT				Project Ref	3347
PERIODS-B AND -C RECONSTRUCTION DRAWINGS				Drawing No.	2
Drawn By	J Clubb	Revision No	-	Date of original survey	2008
				Date of this revision	2008

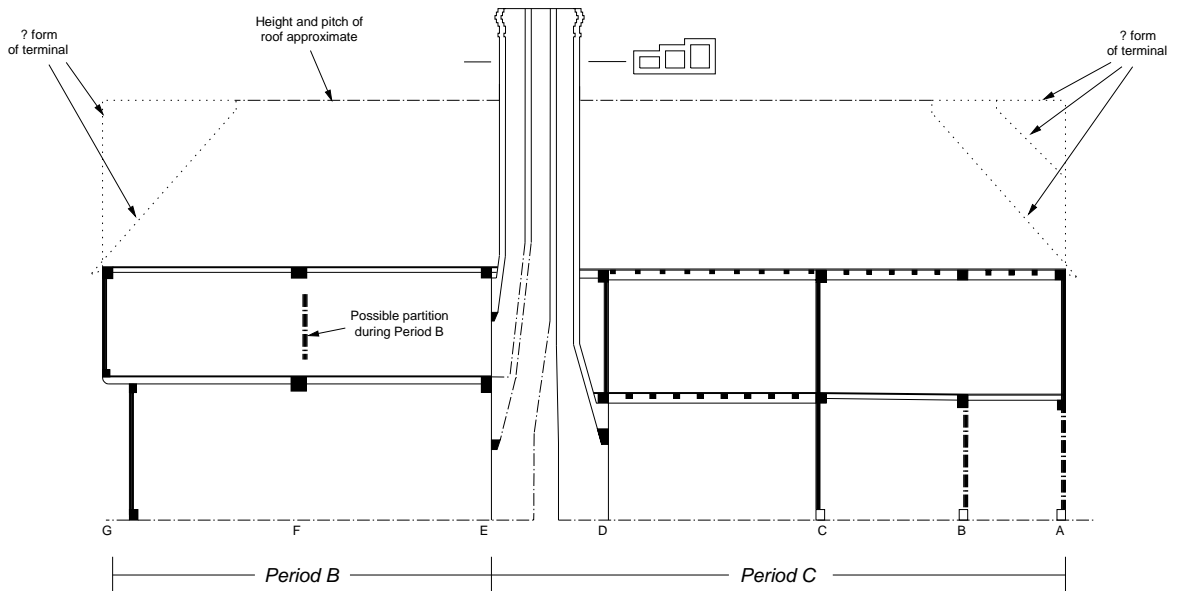

LONGITUDINAL SECTION X-X
 LOOKING SOUTH

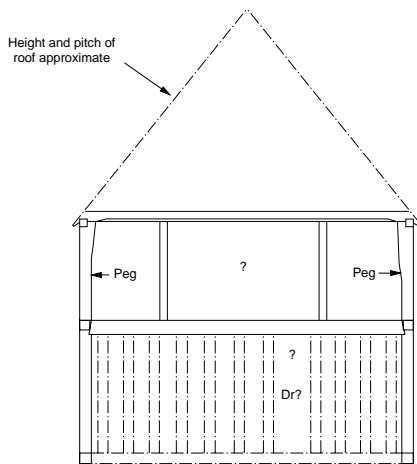

TRUSS E-E VIEWED FROM WEST
 AS DURING PERIOD B
 [ABUTTING PERIOD-A BUILDING
 (now demolished) NOT SHOWN]

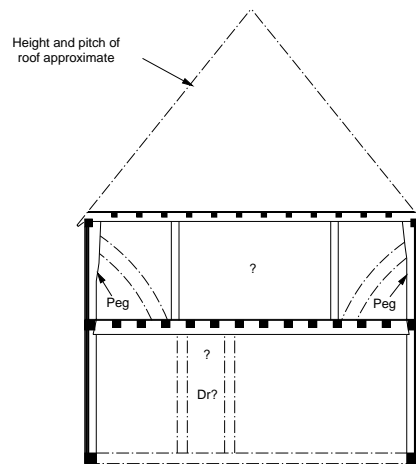

TRUSS E-E VIEWED FROM EAST
 AS DURING PERIOD B



CHILLMILL MANOR, BRENCHLEY, KENT				Project Ref	3347
PERIODS-B AND -C RECONSTRUCTION DRAWINGS				Drawing No.	3
Drawn By	J Clubb	Revision No	-	Date of original survey	2008
				Date of this revision	2008

NB. HEIGHT AND PITCH OF ROOF KNOWN APPROXIMATE ONLY

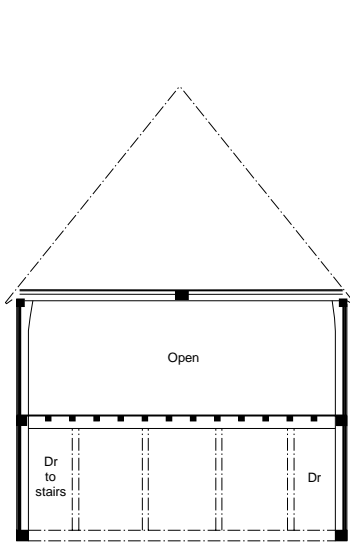

**TRUSS B-B
 FROM EAST**

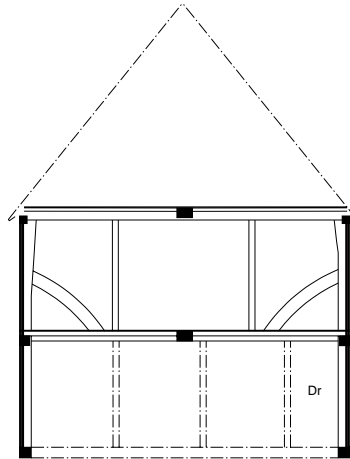

**TRUSS C-C
 FROM EAST**

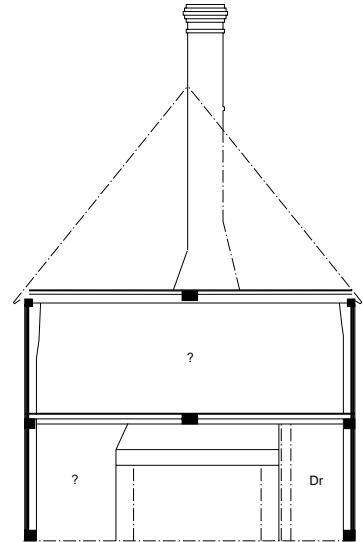

**TRUSS D-D
 FROM WEST**

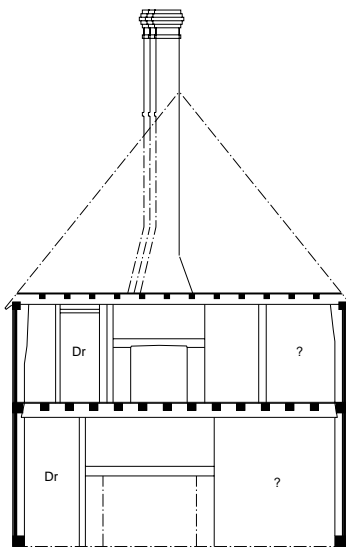

**TRUSS E-E VIEWED FROM EAST
 AS DURING PERIOD C**

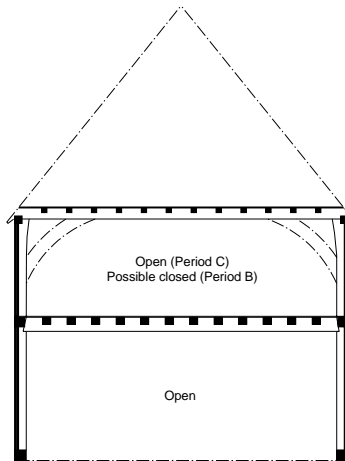

**TRUSS F-F
 FROM WEST**

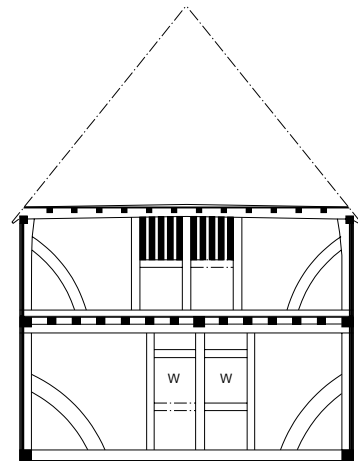

**TRUSS G-G VIEWED FROM INTERIOR
 (WEST)**



**CHILLMILL MANOR, BRENCLEY, KENT
 PERIODS-B AND -C RECONSTRUCTION DRAWINGS**

Project Ref **3347**

Drawing No. **4**

Drawn By **J Clubb**

Revision No -

Date of original survey **2008**

Date of this revision **2008**

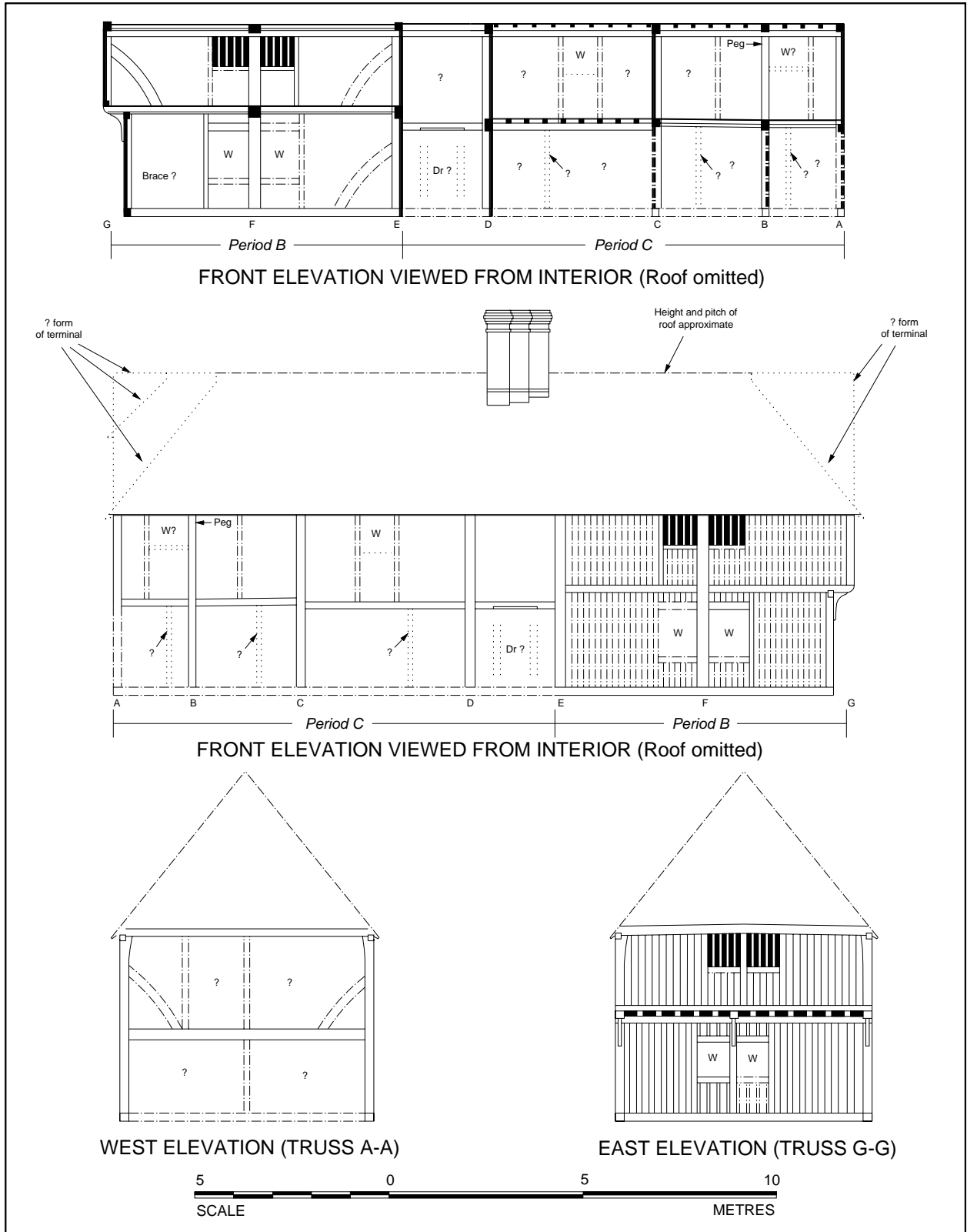

CHILLMILL MANOR, BRENCHLEY, KENT				Project Ref	3347
PERIODS-B AND -C RECONSTRUCTION DRAWINGS				Drawing No.	5
Drawn By	J Clubb	Revision No	-	Date of original survey	2008
				Date of this revision	2008

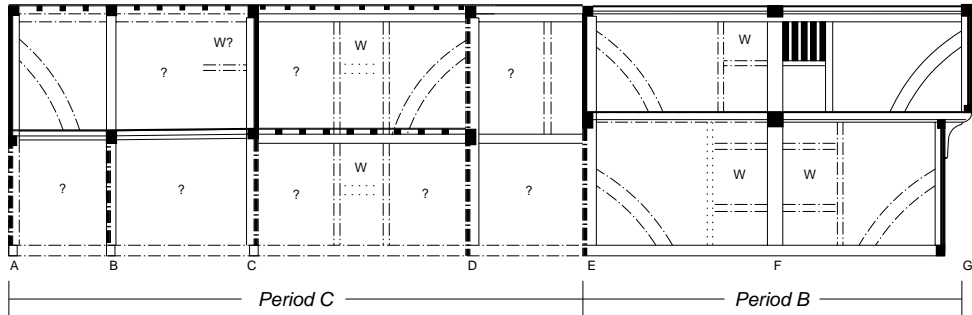

REAR ELEVATION VIEWED FROM INTERIOR
 (Roof omitted)

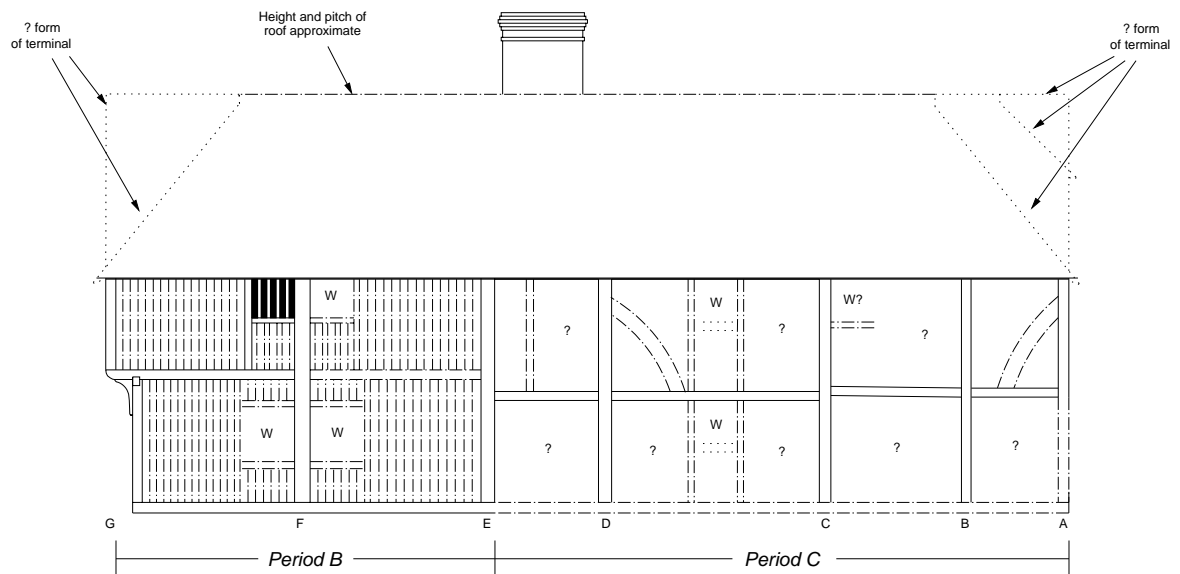

REAR ELEVATION VIEWED FROM EXTERIOR
 Close studding shown approximate only



CHILLMILL MANOR, BRENCHLEY, KENT				Project Ref	3347
PERIODS-B AND -C RECONSTRUCTION DRAWINGS				Drawing No.	6
Drawn By	J Clubb	Revision No	-	Date of original survey	2008
				Date of this revision	2008

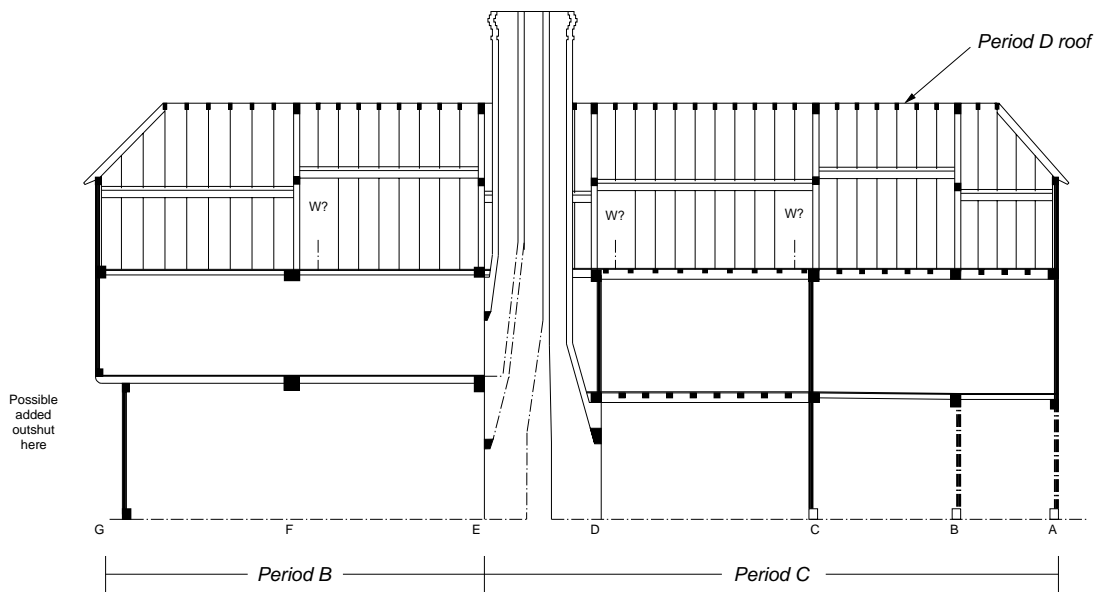

LONGITUDINAL SECTION X-X LOOKING SOUTH

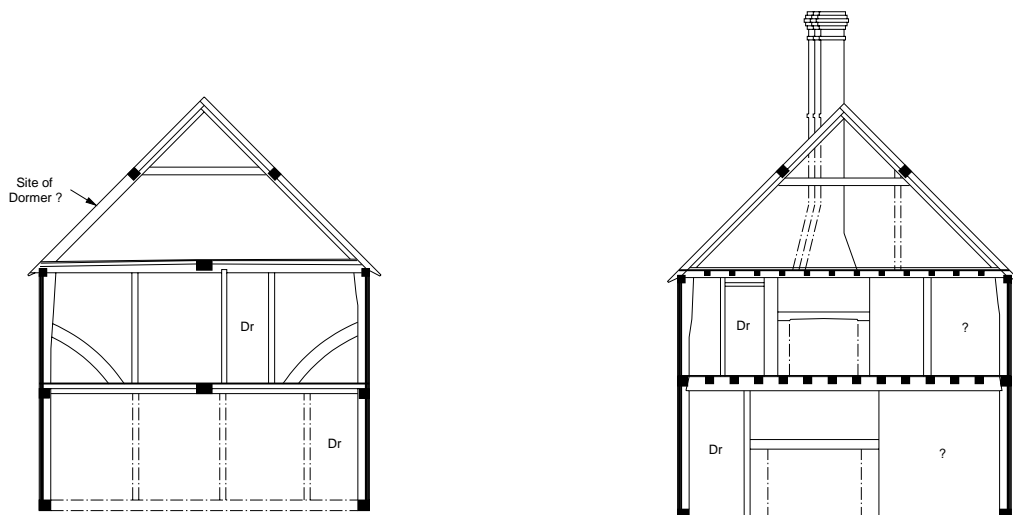

TRUSS C-C
 FROM EAST

TRUSS E-E
 FROM EAST



CHILLMILL MANOR, BRENCLEY, KENT				Project Ref	3347
PERIOD-D RECONSTRUCTION DRAWINGS				Drawing No.	7
Drawn By	J Clubb	Revision No	-	Date of original survey	2008
				Date of this revision	2008

Head Office
Units 1 & 2
2 Chapel Place
Portslade
East Sussex BN41 1DR
Tel: +44(0)1273 426830 Fax:+44(0)1273 420866
email: fau@ucl.ac.uk
Web: www.archaeologyse.co.uk



London Office
Centre for Applied Archaeology
Institute of Archaeology
University College London
31-34 Gordon Square, London, WC1 0PY
Tel: +44(0)20 7679 4778 Fax:+44(0)20 7383 2572
Web: www.ucl.ac.uk/caa

The contracts division of the Centre for Applied Archaeology, University College London 

©Archaeology South-East