

**An Archaeological Evaluation on
Winton House, Alfriston,
East Sussex**

**Commissioned by
Juliet Nicolson**

Project Ref. 3138



**by
David Martin FSA IHBC MIFA & Barbara Martin AIFA**

October 2007

**AN ARCHAEOLOGICAL
INTERPRETATIVE SURVEY
OF
WINTON HOUSE, ALFRISTON,
EAST SUSSEX**

**Commissioned by
JULIET NICOLSON**

PROJECT REF. 3138

**by
David Martin FSA IHBC MIFA
&
Barbara Martin AIFA**

**Archaeology South-East
Institute of Archaeology
University College London**

2007

STANDING BUILDINGS

ARCHAEOLOGICAL INTERPRETATIVE SURVEYS

AN INTRODUCTORY NOTE

ABOUT THESE SURVEYS

The intended purpose of an *Archaeological Interpretative Survey* is to give an overview of the date, sequence of construction, and principal architectural features of a building. As such, they should not be regarded as a detailed archaeological record, nor should they be taken as definitive. Further research, particularly that undertaken during building works, is likely to refine and extend the archaeological record.

These reports are aimed at three groups of user, namely those owners who wish to know more about their property, those persons (architects and planners) who are charged with the responsibility for both conserving the buildings and ensuring that they are carefully adapted to the needs of the future, and finally the academic carrying out wider historical or archaeological research,. A secure use for the future is, in our opinion, the only way of ensuring the long-term survival of any historical building.

INVESTIGATIVE TECHNIQUE

Unless noted to the contrary, the assessments involve a visual inspection of the fabric, both internally and externally, including any accessible roof voids and basement areas. Except where building works are being carried out, intrusive techniques are inappropriate. Interpretation of the fabric and fittings therefore relies principally upon inspection of the visible evidence. As part of the interpretative procedure, a measured outline survey of every property is undertaken.

THE WRITTEN REPORT

For ease of reference the written reports are divided into sections under a series of headings and sub-headings. The typical sequence of headings is as follows:-

- 1 Location of the building.
- 2 Sequence of development.
- 3 Detailed architectural description, arranged period-by-period.

THE DRAWINGS

A set of drawings produced from an measured outline survey is included within the body of each report. The purpose of these drawings is to identify the features included within the written text and to illustrate, as far as is known, the form of the structure during its various stages of development. For clarity the drawings have been prepared in the form of scale 'sketches', rather than detailed archaeological record drawings. For reasons of economy, the making of detailed archaeological drawings is restricted to stripped-out or exceptionally important buildings.

The symbols as used in the drawings attached to this report are as follows:

—————	Surviving Timber-Framed Wall
///////	Surviving Brick or Stone Wall
-----	Features evidenced but destroyed or masked from view
- - - - -	Beam or feature immediately overhead
.....	Conjectural or very approximate
■	Structural timber
?	Details unknown or doubtful

OTHER CONVENTIONS USED -

1 Doors are shown in plan only where known: hence rooms may appear to have no obvious means of access.

2 With the exception of rafters, wallplates, and some chimneys and roof-lines, sections show features cut by or immediately adjacent to the cutting line only.

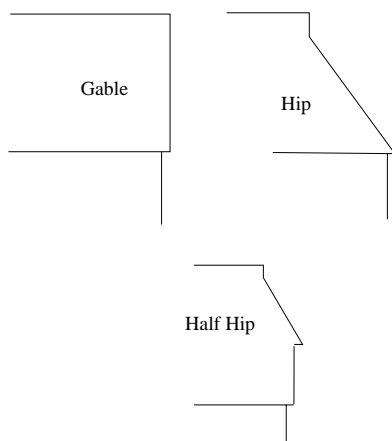
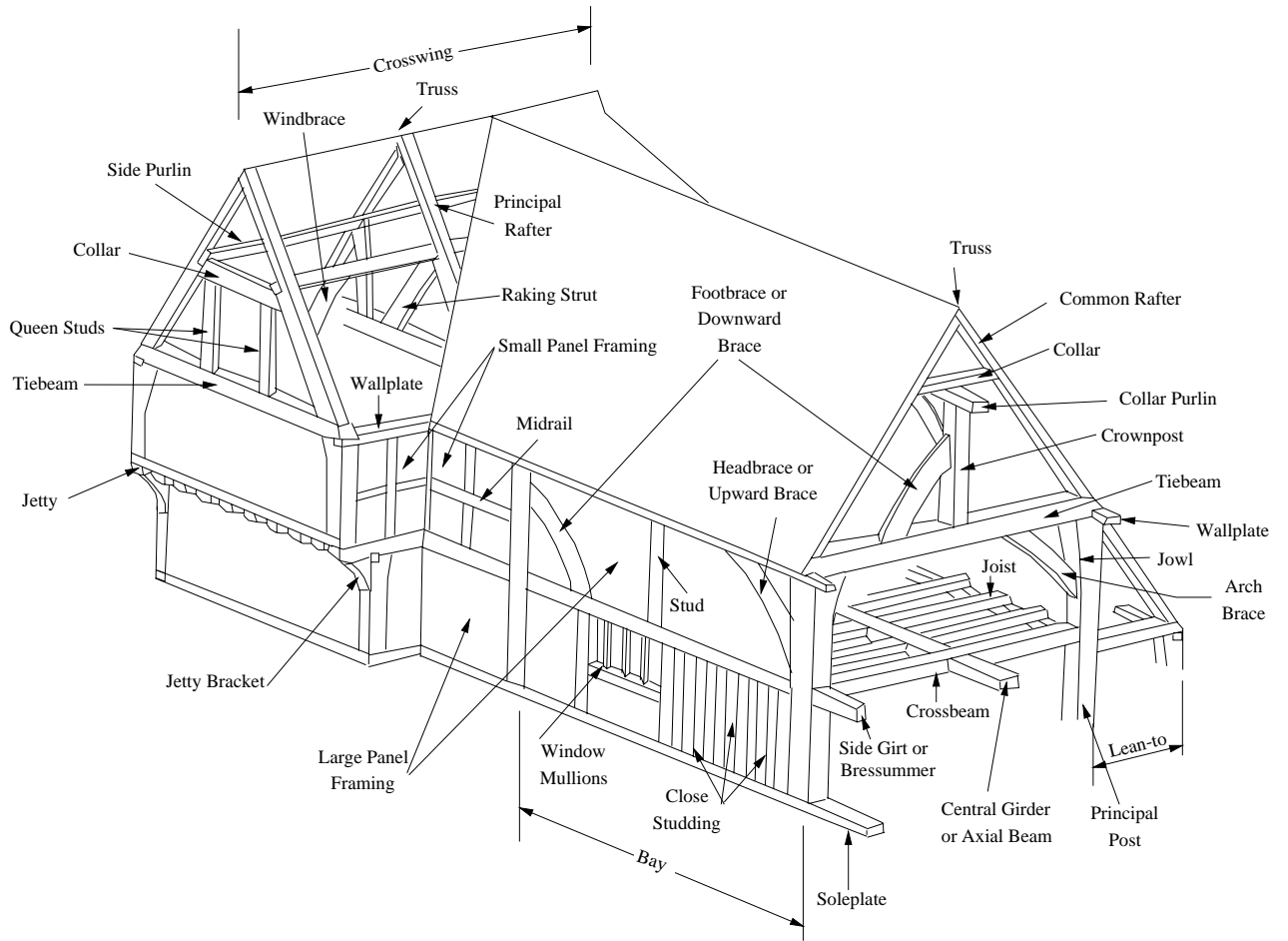

Roof Terminals

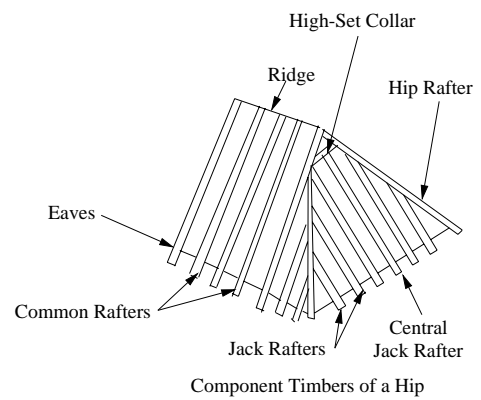

Component Timbers of a Hip

GLOSSARY OF PRINCIPAL TERMS

REPORT NO. 1667

ALFRISTON - WINTON HOUSE

NGR TQ 5215 0384

LOCATION

Winton House, half a mile to the north of Alfriston Church and village, stands on the northern side of Winton Street, which runs westwards from the Upper Dicker to Alfriston village highway. The house itself is located at just under 20 metres above mean sea level and is built at the top of a steep bank which rises from the street, access today being via a drive which leaves the street a little distance to the west of the house. A flight of redundant steps climb the bank, indicating that in the past pedestrian access was possible direct from the street. The building is of 'T' plan with the head of the 'T' formed by a long east-west aligned range which faces north, away from the highway. This arrangement, however, is the result of alteration (see below). To the north of the house's western end is a dovecote, and to the south-west a two-storeyed outhouse, open at ground-floor level along its northern side. There are other former farm buildings further to the west.

HISTORICAL NOTE

No documentary research has been carried out in the preparation of this present report. The summary which follows is based upon an entry contained within a document entitled '*Alfriston Tenement Analysis*' a copy of which is lodged at the East Sussex Record Office (ESRO). Within that report the historical background has been traced for the period 1750-1843 only.

In the mid 18th century Winton was the principal farm within the tiny hamlet of Winton Street, the lands of which occupied the northern quarter of Alfriston parish. The owners of the farm (Thomas Lucas until 1751, Robert Lucas 1752-1769, and subsequently the Washer family until 1800) were at that period actively purchasing smaller properties within the hamlet and as they were acquired these were subsumed into the main farm. As a result, by 1793 the property consisted of a farmhouse (ie Winton House), 3 cottages, sundry buildings and 551a.2r.13p. of land, of which 217a.2r.31p. were arable, 115a.2r.26p. were in Winton Hither Down, 162a.3r.9p. in Winton Further Down, 4a.1r.27p. in Cotlease and 1 acre was called Horn Acre [ESRO AMS 6164/5 - Map of Winton Farm dated 1793]. A sale particular of 1802 notes that the farm was at that time occupied by John Ade and was located within the parishes of Alfriston and Berwick. The buildings are listed as a farmhouse, 3 cottages, 4 barns with stables and other buildings [ESRO SAS/GA 496-554, 738-744], so it would seem that the dwellings and barns associated with the three smaller properties which had been subsumed into the

farm were retained. The Ade family had taken up their tenancy of the property in 1781 and continued there until it was sold in 1802/3, the new owner being William Stevens. His ownership, however, was short lived and in 1806/7 the farm was sold to Lord Viscount Gage of Firle and was merged into the Firle Estate. From this time until after 1843 the farm continued to form part of the estate and was occupied by short-term tenants.

OVERVIEW OF THE BUILDING [Drawing No. 1667/1-2]

As it exists today Winton House has an east-west aligned range with its principal elevation facing north, away from the road. Mid-way along this, and projecting southwards, is a second range of identical height and width, aligned north-south. Along the remainder of the southern side of the northern range runs a lean-to outshut, and this returns across the western end. There are two chimneys, one of three flues set axially within the northern range and a second of two flues built against the western wall of the southern wing. Immediately to the south of the latter, against the southern end of the south wing's western wall, is a small two-storeyed range which is jettied at first-floor level along its western and southern sides. The dragon post at the intersection of the two jetties survives, together with a carved console bracket. The southern jetty extends across the southern end of the south wing and there is a similar end jetty (in this instance absent of brackets with its ends supported on later piers) at the eastern end of the north range. This latter jetty is easily visible from the main road to Alfriston and, in consequence, is today a principal feature of the house. All roof terminals are of hipped type.

The external appearance of the house gives little indication as to the historical development of the building, which is ascertainable by internal inspection only. Indeed, the northern range (which appears to be the main range of the house when viewed from the exterior) is in fact of more than one build and was originally of two markedly different heights, the present unified appearance having been achieved as a result of a phenomenon known as 'alternate rebuilding'.

Most of the house dates from the years around 1600 (**Period A**) though whether representing one or two building campaigns is unclear. Potentially the earliest section is incorporated within the western end of the northern range and is today exceedingly fragmentary. The best preserved elements are the south and west walls, but even here little original work remains. The fragments are sufficient, however, to indicate that this section of the building was very low, with the eaves located half way up the present storey height of the bedroom which occupies this part of the house. Weathering courses on the axial chimney visible within the present roof void indicate that the ridge of the original roof was only a few feet above the present first-floor ceiling. Given these facts, it is tempting to suggest that the remains are those of an earlier, much lower and more humble house upon the site, but the extant evidence – particularly the size and spacing of the first-floor joists which are evidenced by mortices – indicate that there was little or no difference in date between this low part of the building and the remainder of

the structure. It is possible that this low western end represents an extension made to an earlier house which stood immediately to the east. When the earlier house was reconstructed the still relatively new extension was retained to serve as a utility area to the new, more lofty building. Alternatively, the low range could be contemporary with its much taller neighbour, with the difference in height merely reflecting the service function of this part of the structure – a not unusual feature. Based upon the available information it is impossible to tell which of these two scenarios is correct. It is for this reason that both elements of the c.1600 house are grouped together under the generic head 'Period A' with the low range designated **Period A1** and the more lofty part designated **Period A2** (for clarification see Drawing No. 1667/1).

The period-A2 part of the house is a tall 'L' plan structure, heavily framed, with walls of small-panel design. Investigations undertaken by the authors in July/August 1996 demonstrated that the eastern end wall incorporates within its infill panels exotic ornamental framing typical of the West Midlands and, although no evidence is currently visible, it is possible that other sections of the external wall frame were similarly treated. One arm of the 'L' forms the eastern end of the present north range, with the second arm forming the present southern wing. The frames of both elements are fully integrated with one another. This period-A2 part conforms to no standard plan form, but instead incorporates three similarly-sized rooms on each floor, all with lofty storey heights. There is, in addition, evidence for a circulation passage divided off from the ground-floor eastern room, suggesting that the principal means of access from the exterior was into the passage, but despite this evidence the location of the main entrance remains unproven. Two two-flue chimneys built against the western wall of the period-A2 frame served two of the three rooms and their chambers above, the northern of the two chimneys being sited within the low period-A1 section of house. The quality of the fireplaces serving the southern room and chamber show that these were regarded as the principal apartments of the house (ie Parlour and Parlour Chamber) and this impression is confirmed by the presence of a contemporary cellar located beneath this part of the building. The eastern room and chamber appear never to have been heated. The roofs are of interrupted-side-purlin construction with continuous common rafters. Although both the eastern and southern roof terminals are today hipped, when first built both were gabled, probably jettied forward so as to protect projecting oriel windows beneath.

In the early part of the 17th century (**Period B**) a small two-storeyed turret-like jettied wing was added to the southern end of the south range's western wall, immediately to the south of the external chimney. The purpose of this wing has not been ascertained, but it probably served as a best buttery (ground floor) and closet (first floor).

During the middle years of the 18th century (**Period C**) the low western section of the house was rebuilt to the same height as the remainder, a third flue was added to the axial chimney, and lean-to outshuts were constructed to south and west. All period-C external walls are of brick dressed flintwork. Almost certainly it was during this phase of alterations that the gables within the period-A2 part of the house were reconstructed as hips.

In the 19th century a lean-to outshut was added to the south of the eastern range, though a difference in wall construction suggests that this may have been built in two phases - the eastern part is flint built, whilst the wall of the western part is brick. The period-A2 part of the north wall was encased in brick from ground to eaves and the ground-floor part of the eastern wall was reconstructed using brick-dressed flintwork, retaining the jetty. Most of the windows at this end of the house were changed to double-hung sash type, though the first-floor window in the eastern jettied end is a horizontal sliding sash. It is within the western part of the new lean-to area that the present stairs rise, but a blocked external doorway immediately to the south of the stairs shows that they must have been moved here late in the building's history: the earlier location of the stairs remains unknown. A single-flue chimney added to serve the present sitting room (second parlour) within the east range has its back wall set hard against the northern face of the southern passage. The position of the chimney indicates that it was at this date that the chamber above was divided into two, the newly-formed easternmost chamber being accessed via a first-floor passage to the south of the chimney, above the passage on the ground floor. During this general period the front jambs of the hall fireplace were rebuilt using a larger brick than previously.

For outline plans of the building as it currently exists (2007) see Drawing No. 1667/2. As the plans show, a number of minor modifications have been made to the internal layout of the building during the 20th century in order to make the interior more suitable for modern living. Some of these modifications incorporate secondhand material in an attempt to blend the new with the old. The first-floor ceilings above bedrooms 2 and 5 and over the northern half of bedroom 1 have been replaced using modern joisting. Similarly, the first-floor joists over the kitchen have been replaced in modern timber, this having been necessary in order to overcome severe subsidence at this end of the building. Almost all daub infill has been replaced by modern materials. The parlour fireplace appears to have lost its stone arched head during earlier modifications: some attempt has been made at redressing this by inserting a new, but rather inappropriate timber 'lintel'. The hall fireplace has been skinned in modern brickwork. Various of the window and door openings have been adjusted.

All work carried out since period C is excluded from the more detailed architectural description which follows.

LISTED STATUS OF THE BUILDING

Winton House, Winton Street, was listed grade II on 30th August 1966, its listed building reference being TQ 5203 39/101. The description in the list entry is purely for the purpose of recognition and is normally, therefore, primarily based on external appearance. The date is given as C17 or earlier. [Source: English Heritage, Images of England - website]. The description must not be treated as a comprehensive schedule of those elements which are legally protected as, no matter what the grade, the

legislative cover not only relates to both the interior and exterior, but also extends to any building within the curtilage which predates the 1st July 1948. The dovecote to the NW of the house is listed in its own right (Ref. TQ 5203 39/101A, date given as C17).

DETAILED ARCHITECTURAL DESCRIPTION

PERIOD A1 (Late 16th C/c.1600) [See Drawing Nos. 1667/3-5]

The two bays of this low two-storeyed service area are incorporated into the western end of the present house. It has a single ground-floor room with chamber above and measures 5.80 metres (19'0") long x 5.40 metres (17'9") wide. The storey height on the ground floor was approximately 2.20 metres (7'3") floor to floor, but only c.1.20 metres (c.4'0") from floor to top of wallplate within the first-floor chamber, the latter measurement being difficult to ascertain accurately due to severe subsidence in antiquity at the south-western corner of the frame. Given the low first-floor storey height, the first-floor chamber would have been open to the roof above.

The present first-floor joists represent modern replacements, levelled to overcome the subsidence, but mortices in the western face of the crossbeam of truss B1-B2 indicate that the original joists were aligned east-west, along the axis of the building, measured 105 mm wide and were positioned at 470 mm centres. They were lodged over the crossbeam at their western end (at A1-A2). Both the width of the joists and their wide centres indicate that the period-A1 frame is not early, but dates from the late 16th-century at the earliest. Weathering courses on the chimney serving the adjacent period-A2 structure make clear that the period-A1 work was either built at the same time as the period-A2 chimney or already existed. The quality of the surviving period-A1 framing is inferior to that within the main period-A2 part of the house, but this could merely reflect the lesser status of the period-A1 part and need not indicate a difference in construction date.

On the first floor truss A1-A2 retains a full height 190 mm x 130 mm intermediate post at mid span, together with the northern half of its 190 mm x 140 mm tiebeam - the southern half was removed when a modern walk-in dormer window was intruded. Beneath the northern end of the tiebeam is a 70 mm x 140 mm headbrace which rises from the principal post, the latter now partially encased within the period-C northern flint wall. In the tiebeam, immediately to the south of the brace, is a pegged mortice for a stud, dividing this northern half of the west wall into two panels. Round-ended stave holes indicate the former locations of staves which supported the daub infill of the wall. The only other period-A1 framing visible is within the southern wall, where principal posts A2 and B2 survive, together with the badly subsided wallplate. Post B2 carries the southern end of the crossbeam which supported the first-floor joists, but is absent of jowled head and never supported a tiebeam at wallplate level. Instead, a dovetail joint in the top of the wallplate, 180 mm to the west of the post, indicates the former position

of the tiebeam. Extending across the building at only c.1.20 metres (4'0") above the floor, it must have made the first-floor chamber very inconvenient, reinforcing the notion that this area was most likely used for storage or similar. Further to the west the wallplate contains two peg holes, the locations of which are consistent with a central stud with a headbrace to the west, repeating the pattern seen in the end wall. No parts of the roof survive, having been reconstructed in the early/mid 18th century when the walls were raised to give a more unified appearance to the house. However, incorporated within the later roof are four reused principal rafters from a clasped-side-purlin roof. The rafters are of diminished type and have mortices in their side faces for former windbraces. There is a strong possibility that these are reused from the period-A1 build. The former height of the roof is indicated by redundant projecting weathering courses incorporated into the period A2 chimney and, furthermore, the ghost lines left by the rafters are still visible on the western face of the stack, three courses below the projecting weatherings.

PERIOD A2 (c1600) [See Drawing Nos. 1667/3-6]

LAYOUT

The main part of the house comprises two interlinked ranges arranged as an 'L' – a north-south range which measures 11.40 metres (37'4") overall its southern end jetty x 5.15 metres (16'10") wide, and an east-west range which projects eastwards from it and measures 5.95 metres (19'6") overall its eastern end jetty x 5.40 metres (17'9") wide. The two ranges are fully integrated to one another, being linked with their intersecting wallplates framed in level assembly. Of the two, the north-south aligned range is dominant in that it incorporates a truss positioned on the centre line of the east-west aligned range.

Occupying the intersection between the two parts, the northern half of the north-south range served as the hall of the house and has always contained an wide inglenook fireplace. The room within the southern part of the range has a cellar beneath it and is heated by a superior fireplace fitted with stone surround: this room was the parlour. A third room, occupying the east range, was likewise of good-quality, though un-heated and of uncertain use: it is here called the 'second parlour'. Divided from this, on the southern side, is a passage which leads through to the eastern end wall. A mortice in the western face of a stud in wall length D2-E2, together with the large size of the opening immediately to the south of this stud, suggests that the passage may originally have extended westwards, linking it to the period A1 service range to the west, but this point is far from certain. For this reason, the possible line of this section of passage wall is shown in dotted outline in the reconstructed ground-floor plan illustrated in Drawing No. 1667/3, where this unproven part of the passage is shown labelled with a question mark.

The location of the proven length of ground-floor passage suggests that it served as an entrance area, but whether the main external door was in the eastern end wall, or in the southern side wall is impossible to tell. However, whichever was the case, the suggestion is that the principal means of approach to the house, at least by visitors, was from the south, entering the site via the steps which climb the steep bank from Winton Street. This interpretation appears to be supported by the known existence of decorative West Midlands-style framing, above one of the likely candidates for the main entrance, in the eastern end wall of the east-west aligned range. For details of the framing see below under 'wall design'. At some uncertain date in antiquity (but probably later than period A2) an external doorway was inserted through the east wall of the parlour, in the re-entrant angle between the two ranges. Why it was felt necessary to give direct external access to the most private of the ground-floor rooms is unclear. Whatever the precise location of the front door, both the layout of this period-A2 part of the house and the means of entry should be regarded as unorthodox.

The cellar beneath the parlour is reached from steps sited immediately to the north of the parlour chimney. These steps appears to represent the original means of access to the cellar, despite the fact that they are sited within an added period-C lean-to outshut which runs along the southern side of the period-A1 range. Most likely the steps were originally located within a small period-A2 lean-to outshut located upon the same site, roofed in the manner shown in dotted outline in Section Z-Z depicted in Drawing No.1667/5.

The pattern of three similar-sized rooms is repeated on the first floor, but probably without a passage area. How these chambers were reached from the ground floor remains unknown, for there is no obvious location for a period-A2 staircase. The storey height at this upper level are generous – 2.50 metres (8'3") from floor to top of wallplate. From the outset all three chambers were ceiled from the roof void above, the roof area having been intended as an attic space. The attic was probably accessed by ladder from the adjacent period-A1 service chamber.

WALL DESIGN AND WINDOWS

Although the basic methods of constructing the frame are traditional for the period, the building does, nonetheless, incorporate some non-standard features. Some of these come about because of the chosen design, with two ranges intersecting at right angles to give an 'L-plan' footprint. For instance, this is undoubtedly the reason why level assembly has been used at trusses C1-C2 and E1-E2, allowing tiebeams to double as wallplates. But this does not explain why imperfect trusses have been utilized at F1-F2 and H1-H2. In both these locations (which are well away from the intersection of the two ranges) the principal posts (which are jowlless) are not located at the crossbeams and tiebeams, but are instead offset some distance to one side, being deliberately biased towards the end walls of the two respective ranges. The most likely reason for this was to allow uninterrupted lengths of side walls in order to incorporate large windows lighting the rooms. Unfortunately the relevant evidence is masked from view,

so this likely reason cannot be confirmed. With these exceptions, the design of the frame follows standard techniques.

All the walls for which evidence is visible are infilled using small-panel framing, with most midrails being continuous over two panels, the intermediate studs being interrupted by and jointed into them. Set beneath the midrail in the hall chamber face of partition C2-D2-E2 is a footbrace, and peg holes suggest that the end panels of other partitions may have been similarly braced.

At first-floor level within the eastern end wall of the east-west aligned range the small-panel framing is curiously elevated above a rail slightly above the first floor, but otherwise the panels within this wall seemed at first sight to be of standard design. Because of proposed alterations intended in this area in July 1996 a study of this wall was made by the authors. At first-floor level the main frame of this wall comprises two principal posts with jowls of swelling type carrying a tiebeam set in standard assembly. The tiebeam is quite slender. In addition to these three principal components two other timbers were visible in 1996, these being the jambs of a former large central window measuring 2.20 metres wide x c.1.40 metres deep. The jambs are chamfered on their internal leading edge, adjacent to the window, the chamfer being stopped at the level of the former cill. Peg holes in all timbers suggested that other framing either formerly existed or still existed, though further evidence was masked by modern plasterboard. In order to clarify this point, areas of modern plasterboard were removed during August 1996. This revealed that the framing to the north of the former window still survived *in situ*. The area is divided by studs and rails into a block of four panels set above two shallow panels at floor level (see Drawing No 1667/6, East End Wall of North Range). The four panels are infilled with straight diagonally-set struts (two to each panel) forming a diaper pattern entirely alien to the area, but reminiscent of framing used in the West Midlands. The diagonal struts are thin and were intended to be visible on the external face only. Two small areas of the struts were visible where the lath-and-daub infill was damaged, but otherwise the struts are evidenced by peg holes only. Apart from where damaged, otherwise the original daub in this area survives and has a contemporary coat of lime-and-hair plaster internally. The two small panels beneath this area are elaborated with close studding. To the south of the window, peg holes in the main frame indicate an identical wall design here too, but here all detail remains hidden by modern plasterboard and thus the extent of survival in this area is unknown. The original centrally-set window has been removed and replaced by a smaller horizontally-sliding sash of 19th-century date. Removal of the modern plasterboard revealed that the original window cill has been destroyed, as too has a low rail set in-line with the lower rail in the area of wall to the north, together with all other infill framing in this area. It is likely that the window was a projecting oriel supported either on brackets or a cove. As a result of the investigations undertaken in 1996 the proposed modifications in this area were never carried out, and thus the fabric observed at that date remains *in situ*.

It can be certain that no decorative wall infill of this type exists within the panels of those walls of the house which were designed to be internal partitions, but it is currently not

possible to tell whether any other external walls are/were elaborated in this way – the necessary evidence is currently masked from view. To the knowledge of the authors of this report, no other example of West-Midlands-style framing of this type is known in Sussex, the nearest parallel (of similar date) being the Cheshire-style framing which exists at Clayhill, Ringmer, built by the Newton's – a Cheshire family. The feature is therefore all but unique locally and should be regarded as an exotic importation of a non-local wall design.

Except for the evidence for the large window in the eastern end wall described above, the only other possible evidence noted which may suggest the locations of windows is at the southern end of the south range's east and west walls at first-floor level. Here, in both walls the midrail seems to be set at a higher level, as if to double as the cill of a window. The mortice on the northern side of post G1 is exposed to view and is of haunched type. It is reminiscent of a cill mortice for a projecting window. The underside of the wallplate is masked at this point by a modern timber and thus no further details are available.

DOORWAYS

The problems regarding the external doorways has been fully discussed above (see 'Layout'). The opening at the western end of the passage, leading into the hall, is exceptionally wide and extends full storey height. Generally, however, the internal doorways have/had separate heads positioned a little distance down from the ceilings.

FLOORS AND CEILINGS

The 105-mm-wide plain joists within the ceilings of the parlour and hall run north-south along the axis of the range, being jointed into the stop-chamfered crossbeams at both ends. The exception to this is at the extreme southern end of the range where the joists lodge over the plate in order to support a first-floor jetty. This jetty incorporates a fascia beam which masks the joist ends from view. The lower leading edge of the fascia is ovolo moulded, whilst both ends of the jetty are supported on plain console brackets. Although now exposed to view, nail holes in the soffits of the joists indicate that both the hall and parlour once had plastered ceilings. Bearing in mind that the joists are un-chamfered, and having regard for the quality of the building, it is almost certain that these ceilings were original to the period-A2 build.

Within the second parlour too the joists are aligned along the axis of the range, but in this area the range runs at right angles to that containing the hall and parlour and thus here they run east-west. They measure 110 mm x 105 mm in scantling and – unlike within the hall and parlour – they were always meant to be exposed to view, having chamfered lower-leading edges which terminate in splayed stops. The joists extend over the ground-floor wall so as to support an end jetty, and here too there is an ovolo-moulded fascia masking the joist ends. There are likely to have been plain console

brackets at each end, but these have been removed and replaced by masonry piers.

All three first-floor chambers were intended to have ceilings from the outset: the arrangement and scantling of the joists is similar to that utilized on the floor beneath. The ceiling joists at trusses D1-D2, F1-F2 and H1-H2 are jointed into the deep tiebeams, but elsewhere they are lodged into position. At trusses C1-C2, C2-E2 and E1-E2 this is explained by the use of level assembly at these points, but at end trusses G1-G2 and J1-J2 they are lodged over the tiebeams despite the use of normal assembly, the tiebeams being less deep than elsewhere in order to allow this to occur. These joists almost certainly originally extended beyond the walls in order to help carry former overhanging (jettied) roof gables.

STAIRS

The location of the stair giving access to the first floor is currently unknown.

CHIMNEYS

Two two-flue chimneys served the period-A2 ranges, one heating the parlour and parlour chamber whilst the other serves the hall and hall chamber. This latter chimney had a third flue added to its west when the period A1 service area was upgraded in the early/mid 18th century (see below).

Within both the parlour and parlour chamber the fireplaces incorporate stone surrounds, reflecting the high status of these two rooms. The double-ovolo moulded jambs of the surround in the parlour survive, but the head has been removed and replaced in recent times by a plain timber lintel. Both jambs retain their vase bases which are positioned at a high level. On the first floor the stone surround survives intact and is of polished shelly limestone. Here too the chamfered jambs terminate in high vase bases, whilst the four-centred arched head incorporates sunk spandrels elaborated with plain shields.

The second chimney (serving the hall and hall chamber) is constructed within the low period-A1 range and rises against the western face of the period-A2 range's western wall. The hall fireplace is of standard inglenook type, having brick jambs (rebuilt, at least in part) and a heavy timber lintel. Towards the northern end of the lintel is evidence for a spit mechanism. On the first floor the fireplace likewise has brick jambs and a timber lintel. Above, within the roof, survive the projecting brick weathering courses indicating the height of the low period-A1 roof. The chimney cap is of rebated type.

ROOFS

The roofs over the two ranges are set to a relatively shallow pitch and are of interrupted-side-purlin construction with the purlins set at a common level, being morticed and

tenoned into the heavy principal rafters. In order to achieve clear headroom all but one of the internal trusses lack collars, being strengthened instead by means of raking struts. All these trusses are located over tiebeams, into which the principal rafters are jointed. However, because of the intersection of the two ranges the roof truss at C2-E2 is located against the eastern face of the wallplate/tiebeam at this point and therefore the feet of the rafters are not tied to prevent spreading, the rafters being fitted instead into standard birdsmouth joints cut into the plate. For this reason this truss incorporates a collar in order to add strength. Throughout the roofs the common rafters are carried over the backs of the side purlins in the usual manner. Rising from some of the principal rafters and notching into the underside of the purlins are windbraces, but there was never a complete set.

As already noted, at the eastern and southern ends of the ranges it is likely that the roof terminated in overhanging gables, though both have subsequently been converted to hips. A interesting method of construction has been used at the intersection of the two roofs, which were turned at the north-western corner using a hip and at the re-entrant angle by means of a valley. The hip was originally framed in standard fashion using a hip rafter intersecting the north and west slopes, but the intersection between the east and south slopes was not achieved using a fully-framed valley rafter trimming the jacks. Instead, the southern slope was pitched off the western slope by means of a lay board.

PERIOD B (Early 17th C) [See Drawing Nos. 1667/1-6]

LAYOUT

A small, two-storeyed range was constructed against the southern end of the western wall, probably to house a ground-floor best buttery with a closet serving the parlour chamber above. The addition is jettied at its two external walls and therefore the upper storey is larger than that beneath, measuring as it does c.1.90 metres (6'3") east-west by c.2.55 metres (8'4") north-south. The northern side wall is largely formed by the period-A2 parlour chimney, whilst the eastern wall utilized the period-A2 wall framing.

WALL DESIGN, WINDOWS AND DOORWAYS

No details of the infill framing are known, all being masked by later plaster coverings internally and tile hanging externally. Both levels of the addition were accessed via doorways intruded through the side wall of the period-A2 range.

FLOORS AND CEILINGS

The joists and the dragon beam within the ground floor ceiling are currently exposed to view but were originally intended to be masked by a plaster ceiling: they are narrow and

roughly finished. At the south-western corner, beneath the end of the dragon beam, survives the jetty bracket which, unlike those of the period-A2 range, is decorated with geometric designs (Plate 1). Here too the joist ends are masked by an ovolo-moulded fascia, designed to match that on the adjacent range.

The ceiling joists within the first-floor closet are hidden by an under-plastered ceiling.

STAIRS

This small extension was accessed direct from the parlour and parlour chamber and thus no modifications would have been needed to the existing stair arrangements.



Plate 1

ROOF

As is to be expected over such a small structure, the roof is of simple paired-rafter construction, the hipped roof terminal being absent of a high-set collar at its apex. Usually the latter feature would be regarded as an indication of a relatively late date (late 17th century or after) but give the small size of the hip this should be discounted in this instance.

PERIOD C (Early/Mid 18th C) [Drawing Nos. 1667/7-8]

LAYOUT

It was during the early/mid 18th century that the period-A1 range was repaired and raised to match the height and profile of the period-A2 main part of the house. In addition, aisle-like lean-to outshuts were built against the western and southern walls, thereby increasing the size of the ground-floor section. This ground-floor room was now utilized as a bakehouse and wash house, being served by of a new fireplace added against the rear wall of the period-A2 hall chimney. With the increase in storey height, the service chamber became a far more useful space than it had previously been.

WALL DESIGN

The northern wall of the period-A1 part was totally rebuilt at this date using coursed

flintwork with brick dressings to the window openings and quoins, and this same design was used for the walls of the new outshuts to west and south. No original window frames survive. Internally the southern and western walls were raised in height and a new wallplate was added, supported at intervals from beneath by studs.

FLOORS AND CEILINGS

The first floor of the period-A1 range remained in use at this date. A ceiling was presumably inserted into the heightened first-floor chamber, but the present ceiling construction is entirely modern, being flush under-plastered and supported by 20th-century joists.

STAIRS

Steps lead down into the chamber from the period-A2 range, from which the first-floor of the revamped part was accessed.

CHIMNEYS

The new fireplace and flue are straight jointed to the rear of the hall chimney with the tumbling of the flue itself projecting into the chamber above. The brickwork of the fireplace is now masked, but the southern jamb shows signs of where either a bread oven or copper has been removed.

ROOF

Unlike during period A, the roof over the western end of the house was now made to form a continuation of the main roof, thereby unifying the north elevation of the house. It is constructed using clasped side purlins with collars to the trusses. The plate were prevented from spreading by the inclusion of a tiebeam at centre span, but this has been removed and replaced by a tie rod. At the western end the rafters of the lean-to outshut roof are not supported by a tiebeam, but by a heavy-scantling purlin notched into position over the ends of the wallplates.

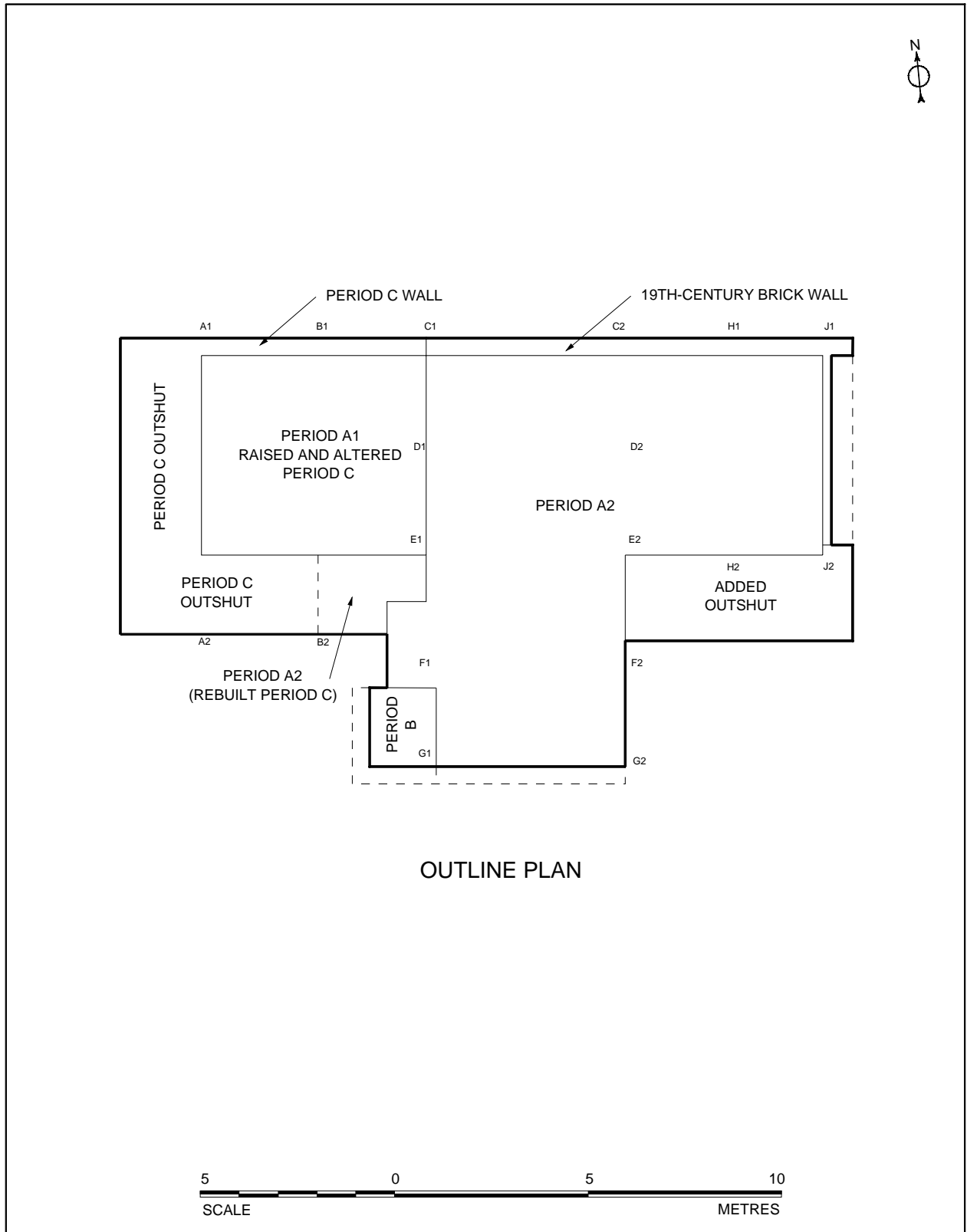

WINTON HOUSE, ALFRISTON, EAST SUSSEX				Site Ref	P52/28
OUTLINE PLAN SHOWING SEQUENCE OF DEVELOPMENT				Drawing No.	1667/1
Drawn By	J Clubb	Revision No	1	Date of original survey	1996
		Date of this revision		2007	

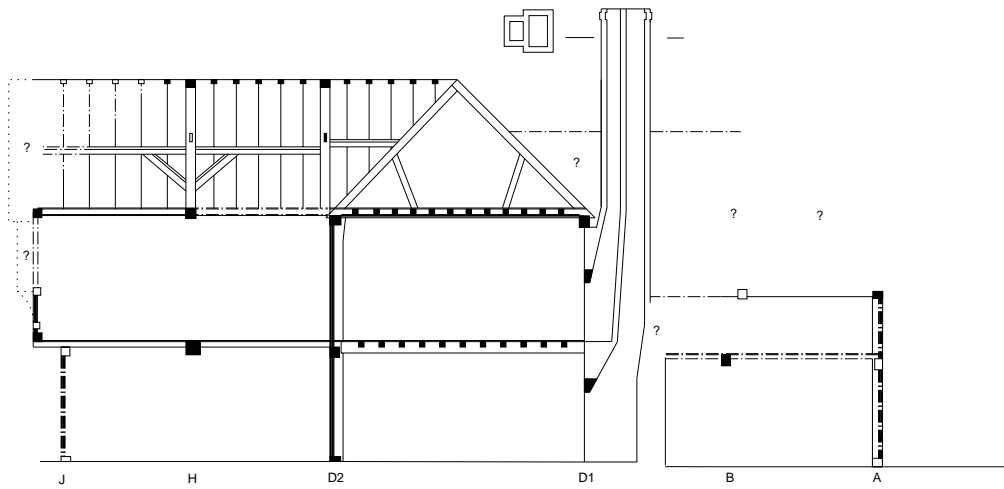

LONGITUDINAL SECTION X-X

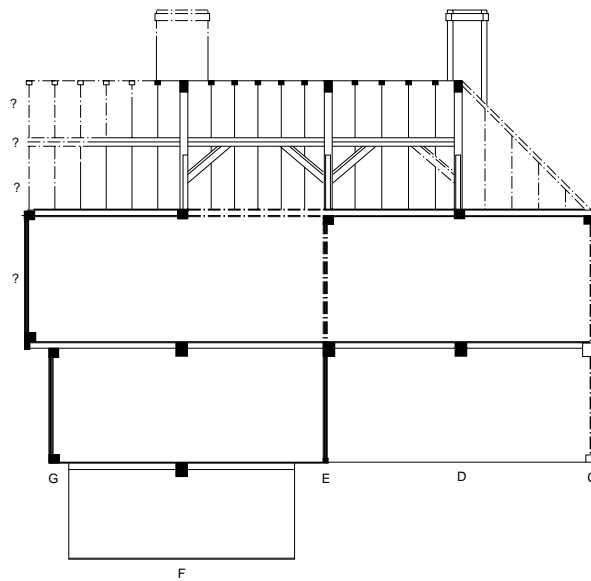

LONGITUDINAL SECTION Y-Y

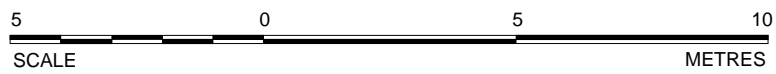

WINTON HOUSE, ALFRISTON, EAST SUSSEX PERIODS-A AND -B RECONSTRUCTION DRAWINGS				Site Ref	P52/28		
				Drawing No.	1667/4		
Drawn By	J Clubb	Revision No	1	Date of original survey	1996	Date of this revision	2007

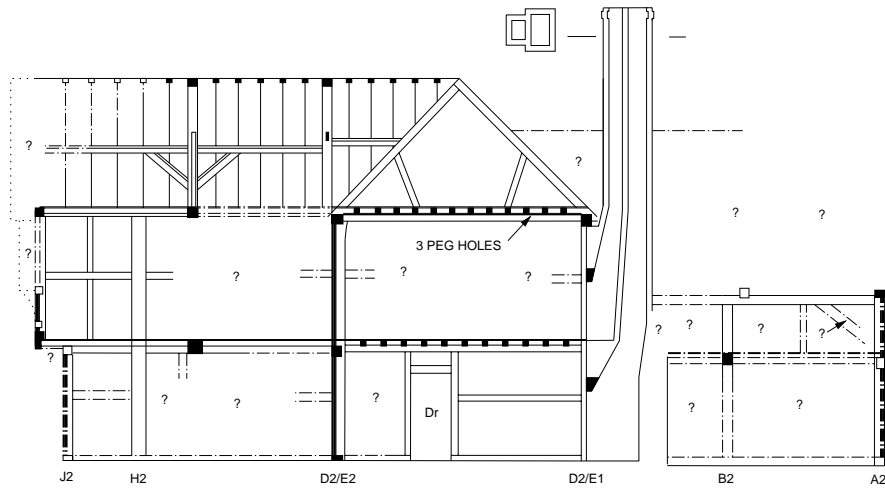

**LONGITUDINAL SECTION X-X SHOWING
SOUTHERN WALL BEYOND**

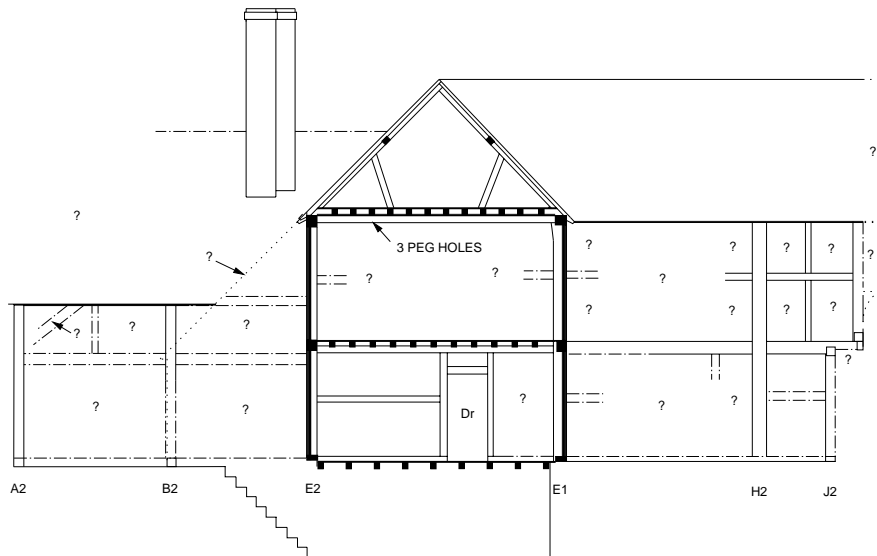

SECTION Z-Z AND PART SOUTH ELEVATION



WINTON HOUSE, ALFRISTON, EAST SUSSEX PERIODS-A AND -B RECONSTRUCTION DRAWINGS				Site Ref	P52/28
				Drawing No.	1667/5
Drawn By	J Clubb	Revision No	1	Date of original survey	1996
				Date of this revision	2007

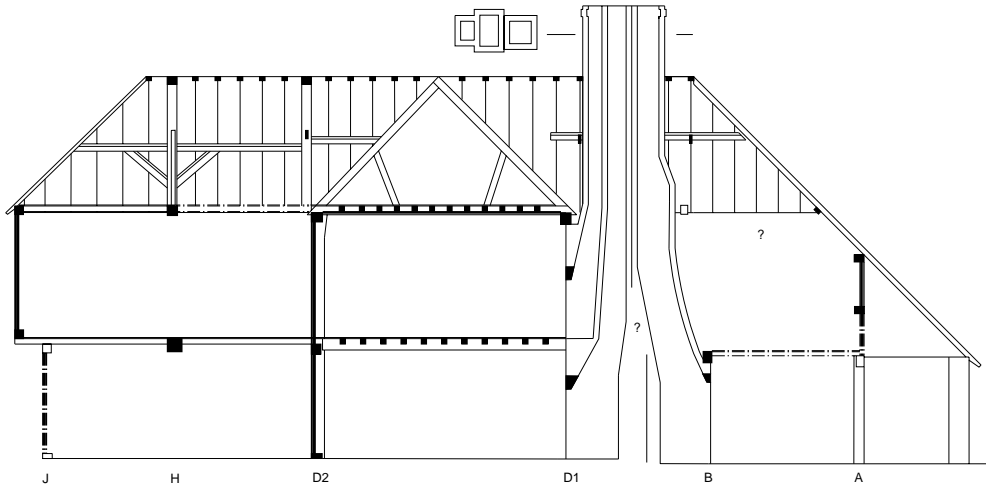

LONGITUDINAL SECTION X-X

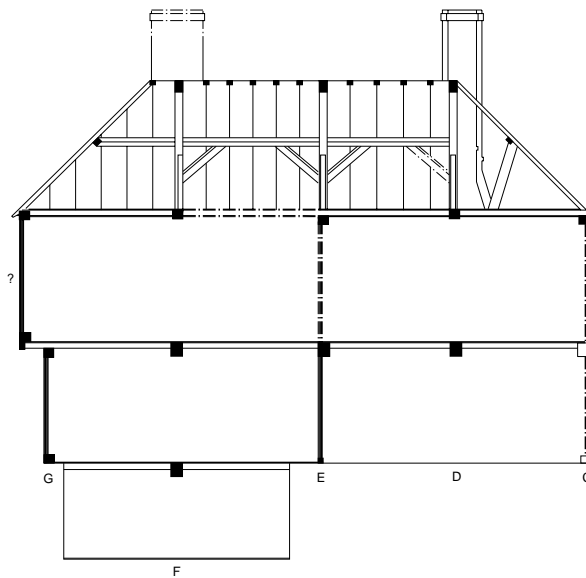

LONGITUDINAL SECTION Y-Y



WINTON HOUSE, ALFRISTON, EAST SUSSEX PERIOD-C RECONSTRUCTION DRAWINGS				Site Ref	P52/28
				Drawing No.	1667/8
Drawn By	J Clubb	Revision No	1	Date of original survey	1996
				Date of this revision	2007

Head Office
Units 1 & 2
2 Chapel Place
Portslade
East Sussex BN41 1DR
Tel: +44(0)1273 426830 Fax:+44(0)1273 420866
email: fau@ucl.ac.uk
Web: www.archaeologyse.co.uk



London Office
Centre for Applied Archaeology
Institute of Archaeology
University College London
31-34 Gordon Square, London, WC1 0PY
Tel: +44(0)20 7679 4778 Fax:+44(0)20 7383 2572
Web: www.ucl.ac.uk/caa

The contracts division of the Centre for Applied Archaeology, University College London 

©Archaeology South-East