

**An Archaeological Watching Brief at
St. Barnabas Hospice, Titnore Lane, Worthing, West Sussex**

Summary Statement

**NGR 510440 104013
Site Code: LNF05**

**ASE Project no. 2844
Report No. 2007030**



**by
Michelle Collings MA AIFA**

March 2007

Abstract

An archaeological watching brief was undertaken at Land at Titnore Lane, Worthing, West Sussex, the proposed site for St Barnabas Hospice. The work was undertaken between the 12th March and 14th March 2007 on behalf of Gifford for their client. The work was undertaken during Geotechnical Investigations carried out for Gifford by Ashdown Site Investigations Limited.

Fourteen Trial Pits (TP) were excavated to a cumulative length of approximately 36.40m. The ground surface level of the trial pits varied between a maximum of 12.54m OD (TP101) and 10.54m OD (TP110) and the underlying natural sediment was encountered at varying depths between 9.54m OD (TP101) and 7.65m OD (TP113). The reduced excavations undertaken by Ashdown Site Investigations Limited varied between 12.14m OD (TP101) and 9.99m OD (TP110).

No archaeological features were observed within Trial Pits 102, 104, 107, 108, 109, 111, 112, 113 and 114. These were excavated through the footprints of trenches from an evaluation undertaken on the site in 2005 (ASE 2005). Trial Pits 101, 103, 105, 106 and 110 excavated outside the footprints of ASE's evaluation trenches did not reveal significant archaeological remains. Two possible features [105/004] and [105/006] were investigated in trial pit 105 however these were both fairly ephemeral and the full extent was not visible within the trench making detailed interpretation difficult.

CONTENTS

Summary Statement

References

Acknowledgements

SMR Summary Sheet

LIST OF FIGURES

Figure 1: Site Location Plan

Figure 2: Trial Pit Location Plan

Figure 3: Plan of Trial Pit 105

1. BACKGROUND

- 1.1 Archaeology South-East (ASE), the contracting division of The Centre for Applied Archaeology at the Institute of Archaeology, University College London, were commissioned by Gifford to undertake an archaeological watching brief during the excavation of geotechnical trial pits on land at Titnore Lane, Worthing, West Sussex (centred NGR TQ 510440 104013) in advance of mixed use development including the construction of a new hospice building on land as shown in figure 1.
- 1.2 An initial pre-determination evaluation of the site undertaken by ASE revealed evidence for multi period occupation of the site dating from the Neolithic through to the post-medieval periods (ASE 2005). A Written Scheme of Investigation (WSI) was prepared by Diccon Hart of ASE (ASE 2007) in response to the *Brief for Archaeological Recording of Geotechnical Investigation Pits* prepared by John Brown of Gifford (Gifford 2007). The methodology laid out in the latter document was followed throughout.
- 1.3 The site consists of two fields, formerly part of Lower Northbrook Farm Titnore Lane Worthing, West Sussex. Archaeology South-East previously undertook an archaeological evaluation of the site during October and November 2005 (ASE 2005). A total of 22 trenches were excavated across the site revealing archaeological features dating from the Neolithic, Bronze Age, Romano-British, medieval and post-medieval periods. The report produced by Jon Sygrave of ASE subsequent to the earlier archaeological fieldwork (ASE 2005) should be referred to for the archaeological background of the site.
- 1.4 The British Geological Survey (Sheet 333) shows the underlying drift geology comprises brickearth over gravel. The site lies between 10.24m AOD to 13.16m AOD. The ground surface level of the trial pits varied between a maximum of 12.54m OD (TP101) and 10.54m OD (TP110) and the underlying natural sediment was encountered at varying depths between 9.54m OD (TP101) and 7.65m OD (TP113).

2. METHODOLOGY

- 2.1 The geotechnical trial pits were excavated across the entire site and where possible were situated within the footprints of ASE's previously excavated archaeological evaluation trenches in areas known to contain no archaeological features, areas that had been investigated and recorded. However it should be noted that this was not possible in all cases and some pits had to be dug outside of trenches for geotechnical testing purposes. Fourteen trial pits were excavated across the development area of which 9 were situated within the footprints of the previous evaluation trenches and 5 (TP's 101,103,105, 106 and 110) were excavated in new areas as shown in

figure 2.

- 2.2 The locations of the geotechnical trial pits were accurately laid out with a Global Positioning System (DGPS) and DGPS Total Station (Leica 1205 R100 Total Station, Leica System 1200 GPS) as shown in figure 2. The trial pits were cut by a mechanical excavator, fitted with a 0.6m wide toothless ditching bucket. The trial pits were excavated under constant archaeological supervision and control until it became clear beyond reasonable doubt that no archaeological remains were present (e.g. once excavation reached undisturbed natural geology). The geotechnical contractor then undertook further excavations to depths up to c.3.00m below ground surface level.

3. RESULTS

3.1 Trial Pits 102, 104, 107, 108, 109, 111, 112,113 and 114 (Figure 2)

- 3.1.1 The trial pits excavated within the footprints of ASE's evaluation trenches did not reveal any archaeological deposits or features that required investigation. The stratigraphic sequence comprised of mixed topsoil/ backfill overlying mixed subsoil/ backfill above natural.
- 3.1.2 No archaeology was observed and artefacts (flint) were only recovered from the upper deposits within trial pit 109.

3.2 Trial Pits 101,103,105, 106 and 110 (Figure 2)

- 3.2.1 The trial pits excavated outside the footprints of ASE'S evaluation trenches revealed a stratigraphic sequence comprising of topsoil overlying subsoil above natural except in trial pit 106 which was excavated through made ground. The topsoil was a mid greyish brown clayey silt. The subsoil was a mid brown clayey silt. The natural was a firm mid orangey brown silty clay.
- 3.2.2 TP 101. This was situated in an area with fairly heavy plant growth and there was root disturbance across the length of the trial pit. No archaeology was observed and no artefacts were recovered.
- 3.2.3 TP103. A possible feature was investigated, this proved to be an ephemeral deposit, with a maximum depth of 50mm (103/004) underlying the subsoil (103/002). It was a mid greyish brown clayey silt, very similar to the subsoil and was located fairly centrally within the trial pit. Flint and burnt flint was recovered from the subsoil (103/002) directly overlying (103/004) and flint was also recovered from (103/004).
- 3.2.4 TP105 (Figure 3). Two pieces of flint were recovered from the subsoil (105/002) along with a small assemblage of pottery comprised of five prehistoric and one Roman sherd, likely to be early Roman. The

subsoil (105/002) also contained an interesting piece of burnt clay of uncertain date. Two possible features were investigated. These were two possible pits/ tree throws¹ [105/004; Figure 3] and [105/006; Figure 3]. Neither was visible in its entirety in plan, both extending beyond the edges of the trial pit. Tree throw/ possible pit [105/004] was very ephemeral and irregular, measuring 0.28m + by 0.36m + by 50mm deep at its maximum depth. It had a very shallow irregular profile [105/004] and was filled by a yellowish greyish brown clayey silt with occasional small stones (105/005) containing flint and a sherd of flint-tempered prehistoric pottery. Possible pit/ tree throw [105/006] was fairly ephemeral but more regular, measuring 0.34m by 0.35m + by 0.20m deep. It had a u shaped profile [105/006] and was filled by a greyish brown silty clay with occasional small stones (105/007).

3.2.5 TP106. Trial pit 106 was situated in an area used for dumping modern waste and made ground was observed. The topsoil (106/001) was a dark brown gravelly silt with Ceramic Building Material (CBM) inclusions and small fragments of concrete overlying made ground (106/002) which was a greyish brown silty gravel with CBM, stone, concrete and modern waste inclusions above natural (106/003), as described above. No archaeology was observed and no artefacts were recovered.

3.2.6 TP110. Root disturbance was observed along the length of the trial pit. Post-medieval Ceramic Building Material (CBM), burnt flint, and flint were recovered from the subsoil (110/002).

1

A **tree throw** or **tree hole** is a bowl-shaped cavity or depression created in the subsoil by a tree.

They are formed either by the long term presence and growth of tree roots or when a large tree is blown over or has its stump pulled out which tears out a quantity of soil along with the roots. The resultant hole will often slowly fill with organic material and can be identified during archaeological fieldwork.

Fresh tree throws also provide a degree of shelter amongst the roots for animals. Some also contain evidence of prehistoric human activity such as flint tools suggesting that they were sometimes used by people in the distant past.

Darvill, T (ed.) (2003). *Oxford Concise Dictionary of Archaeology*, Oxford: Oxford University Press. ISBN 0-19-280005-1

4. THE FINDS

Charlotte Thompson and Lucy Allott

Context	Pottery	Weight (g)	CB M	Weight (g)	Flint	Weight (g)	FCF	Weight (g)	Burnt Clay	Weight (g)
103/002					4	342	1	88		
103/004					1	8	1	6		
105/002	6	42			2	48	39	1202	1	24
105/005	1	6					6	484		
105/007							5	410		
109/001					2	68	2	178		
110/002			1	154	2	32	2	190		

Note: FCF has been discarded

Table 1 Quantification of finds

- 4.1 Small amounts of prehistoric pottery were recovered from two contexts within test pit 105, (105/002) and (105/005). The largest assemblage (105/002) consists of five prehistoric and one Roman sherd. The prehistoric sherds are tempered with sparse to moderate medium to very coarse flint inclusions; one sherd in particular is very densely tempered with flint, and all except for two of the matrices of these are fairly dense with no added quartz. Also in this assemblage is an abraded piece of a Roman lid in a coarse sandy fabric, likely to be early Roman. The context also contains an interesting piece of burnt clay with a flattened side and parallel impressions, possibly from wattle, although this is not clear. Although oxidised, part of the piece has been burnt and is a dark grey colour. The date of this burnt clay is uncertain.
- 4.2 The flint-tempered sherd from (105/005) has ill-sorted flint inclusions and a noticeably oxidised orange surface. Although no diagnostic or feature sherds are present, it is likely that the flint-tempered sherds from this site are of a similar later Bronze Age date to the prehistoric sherds found at the excavation nearby (Thompson 2006).
- 4.3 The piece of brick from test pit 110 (110/002) is post-medieval.
- 4.4 A small assemblage of worked flint was collected during the watching brief. This assemblage originates from topsoil and sub soil contexts in four trial pits.
- 4.5 Flint was recovered from test pit 103 from the subsoil, context (002) and from deposit (004) consisted of flakes, a core and a large piece with several large flake removals (that may be flint from building construction). One of the flakes from (002) was very rounded/smoothed, suggesting it is likely to be residual in this deposit. Test pit 105 contained worked flint including a small flake and a

possible core with flake removals from context (002) and some unworked flint which has been discarded from context (007). Test pit 109 contained a core (rotated several times with roughly 8 flake scars) and a flake was present in the topsoil/backfill of this trial pit. Test pit 110] produced a small flake and a possible core with two clear flake scars.

- 4.6 The assemblage is very limited and much of the flint observed during fieldwork was either burnt or had not been worked. Only worked flints are recorded here. Flints varied from very fresh to rounded suggesting various modes of deposition and that many pieces may have been reworked from their original contexts and redeposited in these subsoil contexts. No pieces were considered diagnostic of period or technology.

5. CONCLUSION

- 5.1 The monitoring exercise was successful in that Gifford, in consultation with John Mills of WSCC, had specifically aimed to avoid disturbing any archaeological deposits that are known to exist on the site. Test Pits were accurately surveyed and tied back within the evaluation trenches as planned. The trial pits positioned outside the footprints of the evaluation trenches did not reveal significant archaeological remains although these results are not indicative of the archaeological potential of the site.

6. REFERENCES

Archaeology South-East 2005: *Lower Northbrook Farm, Titnore Lane, Worthing. An archaeological Evaluation Report*. Unpub. ASE archive report.

Gifford 2007: *Brief for Archaeological Recording of Geotechnical Investigation Pits*.

7. ACKNOWLEDGEMENTS

The co-operation and assistance of John Mills, archaeologist at West Sussex County Council (WSCC) and John Brown of Gifford and his clients is gratefully acknowledged as is that of Rebecca Jones from Ashdown Site Investigations Limited.

APPENDIX A

TEST PIT DETAILS

Test Pit 101

Number	Type	Description	Max Length	Max Width	Max Depth	OD Height (for top of topsoil- ground surface and for top of natural)
101/001	Layer	Topsoil	TP.	TP.	0.20m	12.53m
101/002	Layer	Subsoil	TP.	TP.	0.20m	
101/003	Deposit	Natural	TP.	TP.	N/A	12.14m

Test Pit 102

Number	Type	Description	Max Length	Max Width	Max Depth	OD Height (for top of topsoil- ground surface and for top of natural)
102/001	Layer	Mixed Topsoil	TP.	TP.	0.35m	11.10m
102/002	Layer	Mixed Subsoil	TP.	TP.	0.25m	
102/003	Deposit	Natural	TP.	TP.	N/A	10.50m

Test Pit 103

Number	Type	Description	Max Length	Max Width	Max Depth	OD Height (for top of topsoil- ground surface and for top of natural)
103/001	Layer	Topsoil	TP.	TP.	0.20m	11.52m
103/002	Layer	Subsoil	TP.	TP.	0.25m	

103/003	Deposit	Natural	TP.	TP.	N/A	
103/004	Layer	Mid greyish brown deposit	TP.	TP.	0.20m	11.12m

Test Pit 104

Number	Type	Description	Max Length	Max Width	Max Depth	OD Height (for top of topsoil-ground surface and for top of natural)
104/001	Layer	Mixed Topsoil	TP.	TP.	0.38m	10.85m
104/002	Layer	Mixed Subsoil	TP.	TP.	0.30m	
104/003	Deposit	Natural	TP.	TP.	N/A	10.17m

Test Pit 105

Number	Type	Description	Max Length	Max Width	Max Depth	OD Height (for top of topsoil-ground surface and for top of natural)
105/001	Layer	Topsoil	TP.	TP.	0.26m	10.86m
105/002	Layer	Subsoil	TP.	TP.	0.19m	
105/003	Deposit	Natural	TP.	TP.	N/A	10.41m
105/004	Cut	Cut of tree throw/ possible pit	0.28m+	0.36m+	50mm	
105/005	Fill	Fill of [105/004]	0.28m+	0.36m+	50mm	
105/006	Cut	Cut of tree throw/ possible pit	0.30m	0.35m+	0.20m	
105/007	Fill	Fill of [105/006]	0.30m	0.35m+	0.20m	

Test Pit 106

Number	Type	Description	Max Length	Max Width	Max Depth	OD Height (for top of topsoil- ground surface and for top of natural)
106/001	Layer	Topsoil	TP.	TP.	0.26m	13.59m
106/002	Layer	Made Ground	TP.	TP.	0.24m	
106/003	Deposit	Natural	TP.	TP.	N/A	13.10m

Test Pit 107

Number	Type	Description	Max Length	Max Width	Max Depth	OD Height (for top of topsoil- ground surface and for top of natural)
107/001	Layer	Mixed Topsoil	TP.	TP.	0.25m	10.94m
107/002	Layer	Mixed Subsoil	TP.	TP.	0.25m	
107/003	Deposit	Natural	TP.	TP.	N/A	10.44m

Test Pit 108

Number	Type	Description	Max Length	Max Width	Max Depth	OD Height (for top of topsoil- ground surface and for top of natural)
108/001	Layer	Mixed Topsoil	TP.	TP.	0.30 m	11.45m
108/002	Layer	Mixed Subsoil	TP.	TP.	0.38m	
108/003	Deposit	Natural	TP.	TP.	N/A	10.78m

Test Pit 109

Number	Type	Description	Max Length	Max Width	Max Depth	OD Height (for top of topsoil- ground surface and for top of natural)
109/001	Layer	Mixed Topsoil	TP.	TP.	0.20 m	10.76m
109/002	Layer	Mixed Subsoil	TP.	TP.	0.20m	
109/003	Deposit	Natural	TP.	TP.	N/A	10.36m

Test Pit 110

Number	Type	Description	Max Length	Max Width	Max Depth	OD Height (for top of topsoil- ground surface and for top of natural)
110/001	Layer	Topsoil	TP.	TP.	0.30 m	10.52m
110/002	Layer	Subsoil	TP.	TP.	0.25m	
110/003	Deposit	Natural	TP.	TP.	N/A	9.99m

Test Pit 111

Number	Type	Description	Max Length	Max Width	Max Depth	OD Height (for top of topsoil- ground surface and for top of natural)
111/001	Layer	Mixed Topsoil	TP.	TP.	0.25 m	11.78m
111/002	Layer	Mixed Subsoil	TP.	TP.	0.15m	
111/003	Deposit	Natural	TP.	TP.	N/A	11.38m

Test Pit 112

Number	Type	Description	Max Length	Max Width	Max Depth	OD Height (for top of topsoil- ground surface and for top of natural)
112/001	Layer	Mixed Topsoil	TP.	TP.	0.25 m	10.67m
112/002	Layer	Mixed Subsoil	TP.	TP.	0.35m	
112/003	Deposit	Natural	TP.	TP.	N/A	10.07m

Test Pit 113

Number	Type	Description	Max Length	Max Width	Max Depth	OD Height (for top of topsoil- ground surface and for top of natural)
113/001	Layer	Mixed Topsoil	TP.	TP.	0.33 m	10.65m
113/002	Layer	Mixed Subsoil	TP.	TP.	0.17m	
113/003	Deposit	Natural	TP.	TP.	N/A	10.15m

Test Pit 114

Number	Type	Description	Max Length	Max Width	Max Depth	OD Height (for top of topsoil- ground surface and for top of natural)
114/001	Layer	Mixed Topsoil	TP.	TP.	0.25 m	10.75m
114/002	Layer	Mixed Subsoil	TP.	TP.	0.25m	
114/003	Deposit	Natural	TP.	TP.	N/A	10.25m

APPENDIX B

SMR Summary Form

Site Code	LNF05					
Identification Name and Address	St. Barnabas Hospice, Titnore Lane, Worthing, West Sussex					
County, District &/or Borough	West Sussex					
OS Grid Refs.	NGR 510440 104013					
Geology	Brickearth					
Arch. South-East Project Number	2844					
Type of Fieldwork	Eval.	Excav.	Watching Brief	Standing Structure	Survey	Other
Type of Site	Green Field	Shallow Urban	Deep Urban	Other		
Dates of Fieldwork	Eval.	Excav.	WB. 12-03-07- 14-03-07	Other		
Sponsor/Client	Gifford					
Project Manager(s)	Darryl Palmer					
Project Supervisor	Michelle Collings					
Period Summary	Palaeo.	Meso.	Neo.	BA	IA	RB
	AS	MED	PM	Other	Modern	
Abstract						
<p><i>An archaeological watching brief was undertaken at Land at Titnore Lane, Worthing, West Sussex, the proposed site for St Barnabas Hospice. The work was undertaken between the 12th March and 14th March 2007 on behalf of Gifford for their client. The work was undertaken during Geotechnical Investigations carried out for Gifford by Ashdown Site Investigations Limited.</i></p> <p><i>Fourteen Trial Pits (TP) were excavated to a cumulative length of approximately 36.40m. The ground surface level of the trial pits varied between a maximum of 12.54m OD (TP101) and 10.54m OD (TP110) and the underlying natural sediment was encountered at varying depths between 9.54m OD (TP101) and 7.65m OD (TP113). The reduced excavations undertaken by Ashdown Site Investigations Limited varied between 12.14m OD (TP101) and 9.99m OD (TP110).</i></p> <p><i>No archaeological features were observed within Trial Pits 102, 104, 107, 108, 109, 111, 112,113 and 114. These were excavated through the footprints of ASE's evaluation trenches from an evaluation undertaken on the site in 2005 (ASE 2005). Trial Pits 101,103,105, 106 and 110 excavated outside the footprints of ASE's evaluation trenches did not reveal significant archaeological remains. Two possible features [105/004] and [105/006] were investigated in trial pit 105 however these were both fairly ephemeral and the full extent was not visible within the trench making detailed interpretation difficult.</i></p>						



09

10

11

12

© Archaeology South-East		St Barnabas Hospice, Titnore Lane, Worthing		Fig. 1
Ref: 2844	March 2007	Drawn by: JLR	Site Location Plan	

Reproduced from the Ordnance Survey's 1:25000 map of 1997 with permission of the Controller of Her Majesty's Stationary Office. Crown Copyright. Licence No. AL 503 10 A

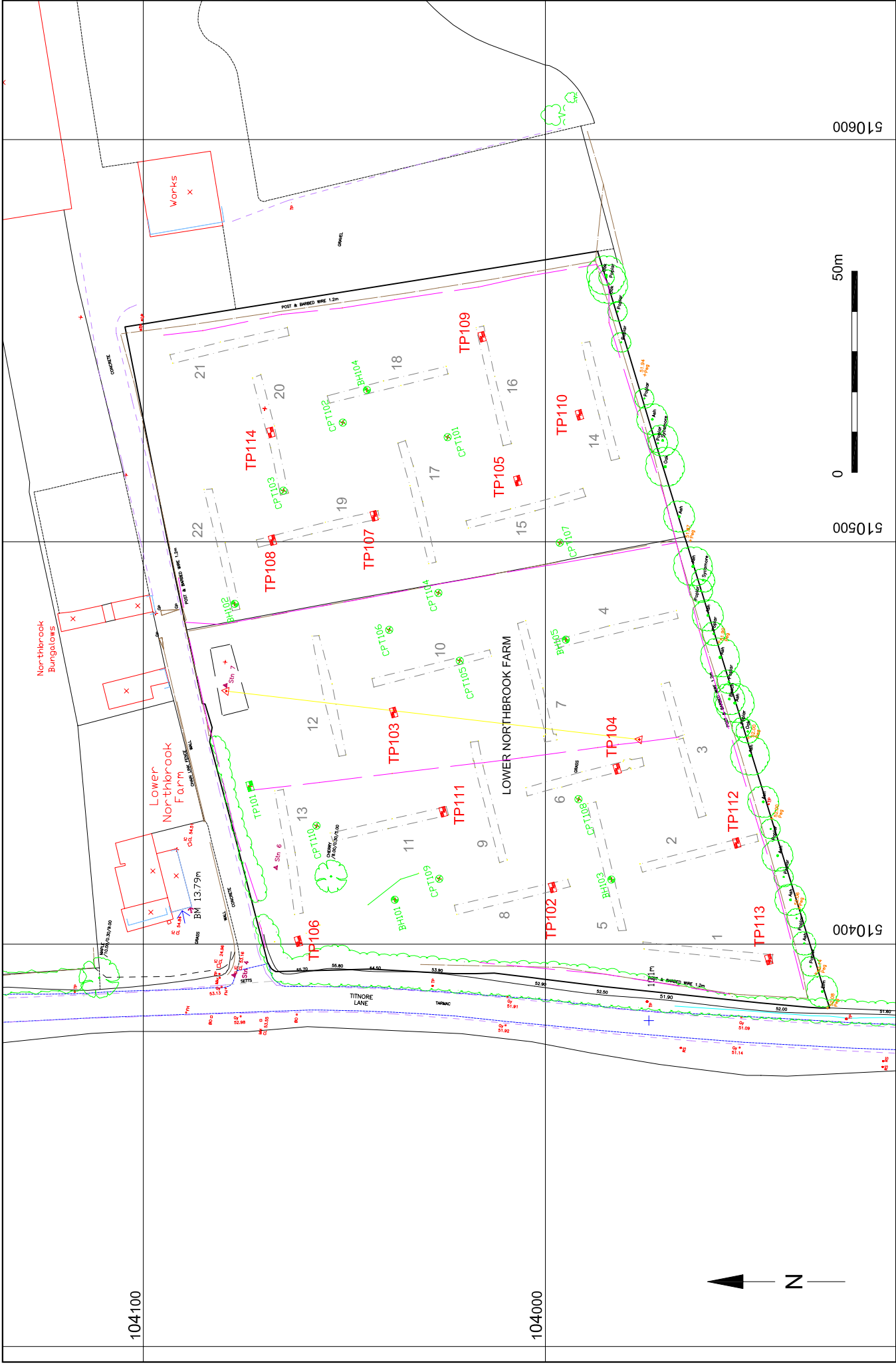

© Archaeology South-East
 St Barnabas Hospice, Titmore Lane, Worthing
 Ref: 2844
 March 2007
 Drawn by:
 JLR
 Trial Pit Location Plan
 Fig. 2

Plan of Trial Pit 105

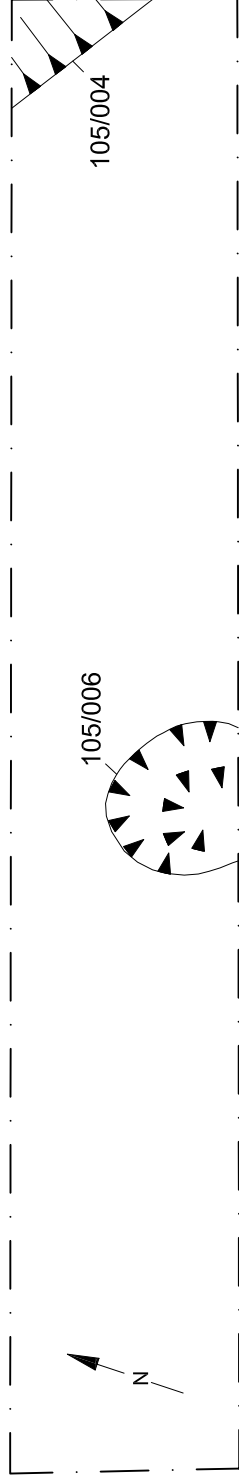

0 1m

© Archaeology South-East		St Barnabas Hospice, Tinore Lane, Worthing	
Ref. 2844	March 2007	Plan of Trial Pit 105	
		Fig. 3	

Head Office
Units 1 & 2
2 Chapel Place
Portslade
East Sussex BN41 1DR
Tel: +44(0)1273 426830 Fax: +44(0)1273 420866
email: fau@ucl.ac.uk
Web: www.archaeologyse.co.uk



London Office
Centre for Applied Archaeology
Institute of Archaeology
University College London
31-34 Gordon Square, London, WC1 0PY
Tel: +44(0)20 7679 4778 Fax: +44(0)20 7383 2572
Web: www.ucl.ac.uk/caa

The contracts division of the Centre for Applied Archaeology, University College London 

©Archaeology South-East